

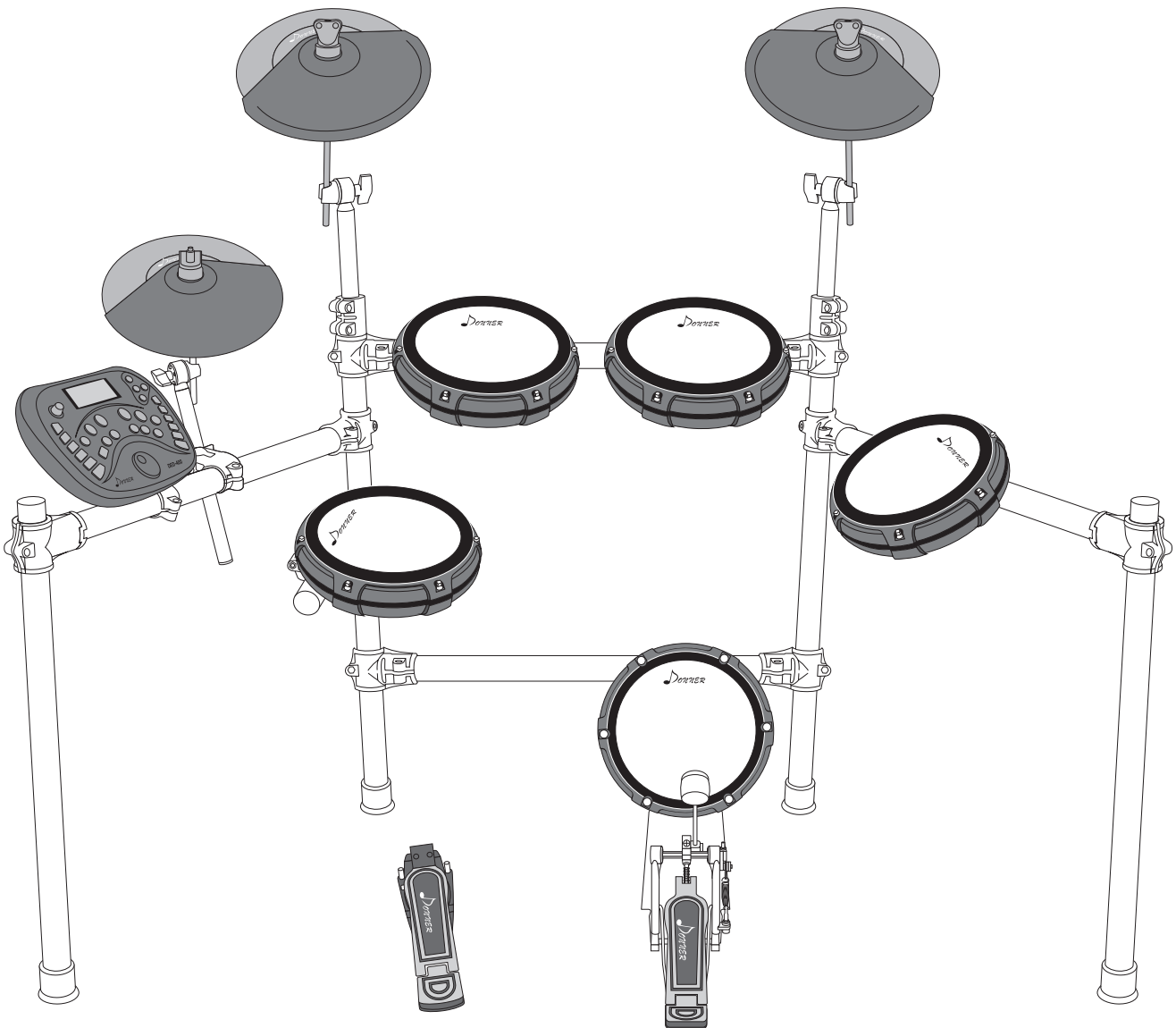

# DED-400

ELECTRONIC DRUM

# User Manuals



简体中文

ENGLISH

This product is subject to change without notice



## Function Introduction

Thank you for choosing our electronic drum. Elegant and delicate electronic drum is the perfect combination of modern new electronic technology.

◆Before using this product, you must read the instructions in detail.



### Adopt DREAM sound source

Its core uses the top French DREAM sound source, digital sampling, to bring a realistic listening experience to your performance.



### Hammered bottom drum pedal

Mechanical simulation of the bottom drum pedal, giving you a real foot pedal feeling.

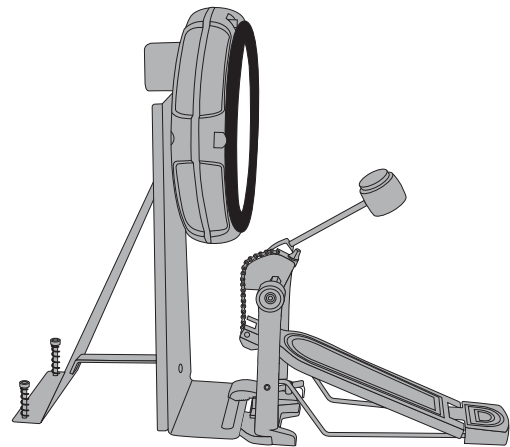

- Use 6 layers of strength layering, closer to acoustic drumming
- Support double trigger, with side response
- 25 preset drum kits, 25 user-defined drum kits
- Number of tones 400 and GM standard tone library (for demo tracks)
- 50 demo tracks with adjustable GM volume and drum set volume (for learning)
- Effects: Reverb type 0-5, 2-band EQ
- Support the sensitivity parameter adjustment of each drum pan
- Tempo control: 30-250 beats per minute
- Metronome: 9 types
- Other functions: custom settings storage, restore factory settings
- Plug: USB MIDI, headphone, audio input, audio output, expansion cymbal jack
- Rub 12", snare 10", toms 8

## REMARK !

---

- This product is an electro-acoustic instrument product. It is normal that there is a little current sound in the speaker or earphone after power-on.  
Keep away from "radio, TV, antenna receiver, router, refrigerator, TV, motor and other RF electrical interference sources" during use.



<b>Function Introduction</b> -----	<b>1</b>
<b>Table of Contents</b> -----	<b>2</b>
<b>Installation Guide</b> -----	<b>3</b>
Checking the included items-----	3
Drum stand-----	4
Drum stand installation-----	4
Installation of support rod and module box-----	5
Installation of strike components-----	6
Kick drum installation-----	7
Insert Connection Line-----	7
<b>Illustration of the main case socket</b> -----	<b>8</b>
Power cord connection-----	8
USB MIDI jack-----	8
Headphone jack-----	8
Audio output jack-----	8
Audio input jack-----	8
Expansion cymbal jack-----	8
<b>Operation Guide</b> -----	<b>9</b>
Power on-----	9
Volume Adjustment-----	9
Drum Set Selection-----	10
User-defined drum set-----	10
Drum Drum Drumming-----	10
Menu Buttons-----	10
Drum Pan Parameter Adjustment-----	11
Song Selection-----	11
Recording-----	12
Effects-----	12
Metronome-----	12
TAP beat metering function-----	12
<b>Exercise function</b> -----	<b>13</b>
<b>Save/Repul</b> -----	<b>14</b>
Expansion Interface-----	14
Drum buttons-----	14
<b>Appendices</b> -----	<b>15</b>
<b>Defining Drum Sets</b> -----	<b>17</b>
Song List-----	17
<b>Product Care</b> -----	<b>18</b>
<b>Safety Precautions</b> -----	<b>19</b>
<b>Warranty Card</b> -----	<b>22</b>



# INSTALLATION GUIDE

## REMARK !

- Please follow the instructions and read the "safety precautions" in the User Manual carefully before using it.
- When you have completed the connection, please turn on the power according to the instructions in the User's Manual and check whether you can hear the sound.
- This product needs adult to install, do not let the minor install it independently.

# 01

## Check the attached items

- After opening the package, please check whether it contains all the items immediately. If there are any omissions, please contact your dealer.



Sound module

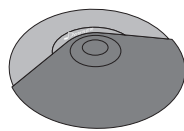

Hi hat

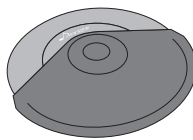

Ride

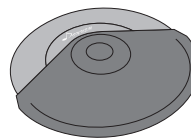

Crash



Tom-tom  
(3pcs)



Snare

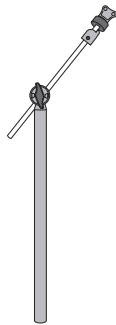

Cymbal mounts  
( 2pcs )

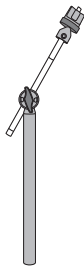

Cymbal mounts  
( 1pcs )

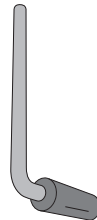

Drum mount  
( 4pcs )

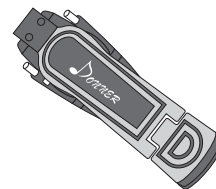

Hi hat pedal



Supporting parts



Fixed parts

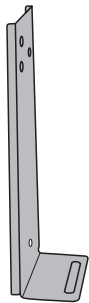

Front support member



Kick

2 pcs 2 pcs 5 pcs



Fastening screw



Stick hammer

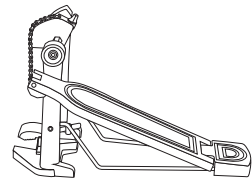

Kick pedal

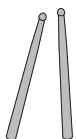

drum stick

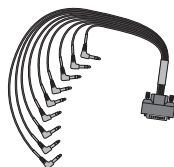

Signal Connection Line



power adapter



Bolt driver



Drum key



# INSTALLATION GUIDE

## 02

### Drum stand

- After opening the package, please check whether it contains all the items immediately. If there are any omissions, please contact your dealer.

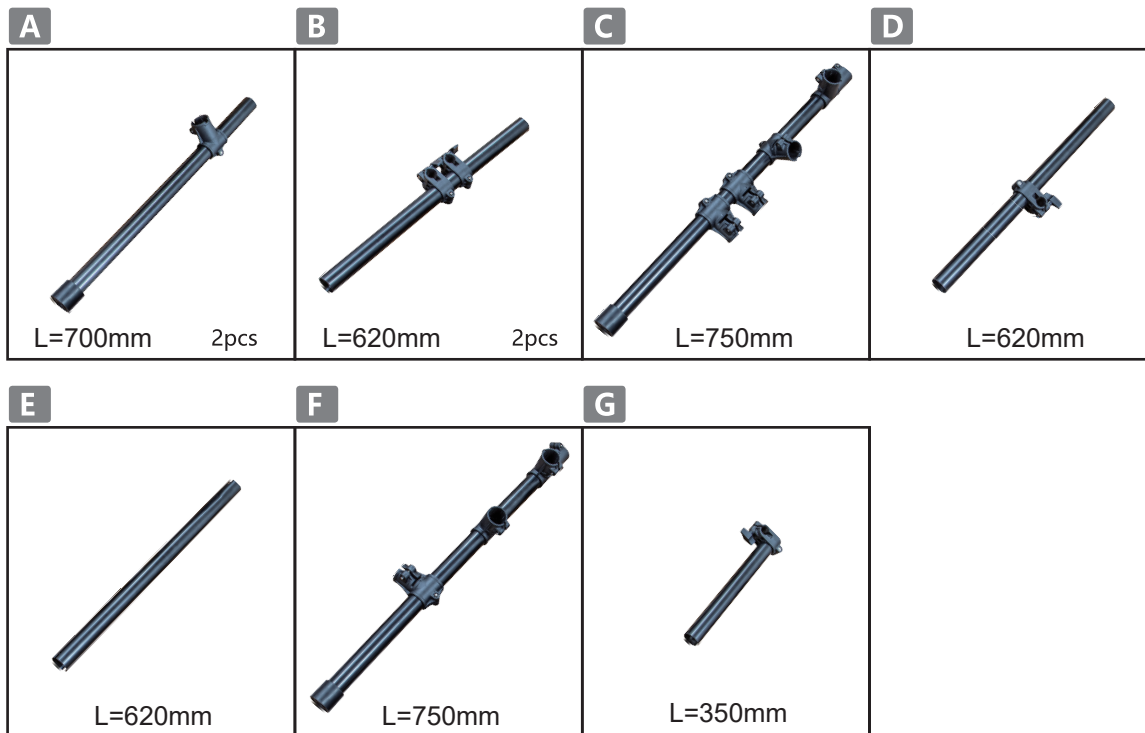

## 03

### Drum stand installation

- During installation, tighten the screws and be careful not to pinch your finger!
- Assemble the drum stand according to the direction indicated.



简体中文

ENGLISH



## 04

### Installation of support rod and module box

- Support rods and module boxes need to be inserted in place, and tighten the plastic head screw to avoid falling.

Insert three cymbal support rods, four drum support rods and module boxes into corresponding positions respectively, and tighten the plastic head screw.

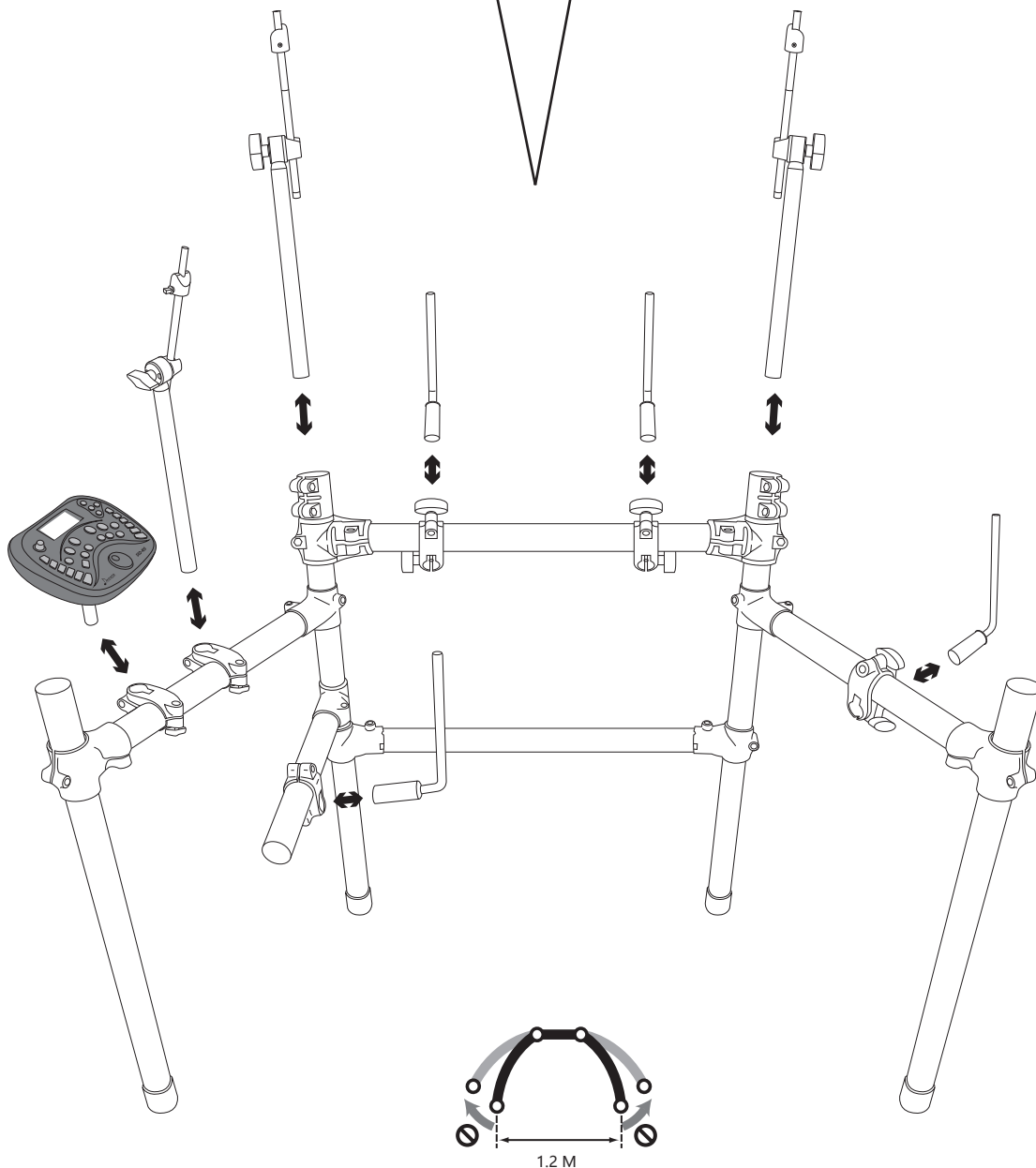
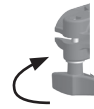

For safety considerations, the expansion width of the bracket should not be greater than 1.2 meters.



# INSTALLATION GUIDE

## 05

### Installation of strike components

- After inserting the drum disc, tighten the screw to avoid loosening.
- Do not screw the cymbals tightly, leave some space for them to sway up and down.

Install cymbals, Tom drums and army drums in corresponding positions according to the figures.

Attention: Each cymbal, Tom drum and army drum has different functions. It needs to be installed correctly with reference to the identification of accessories.

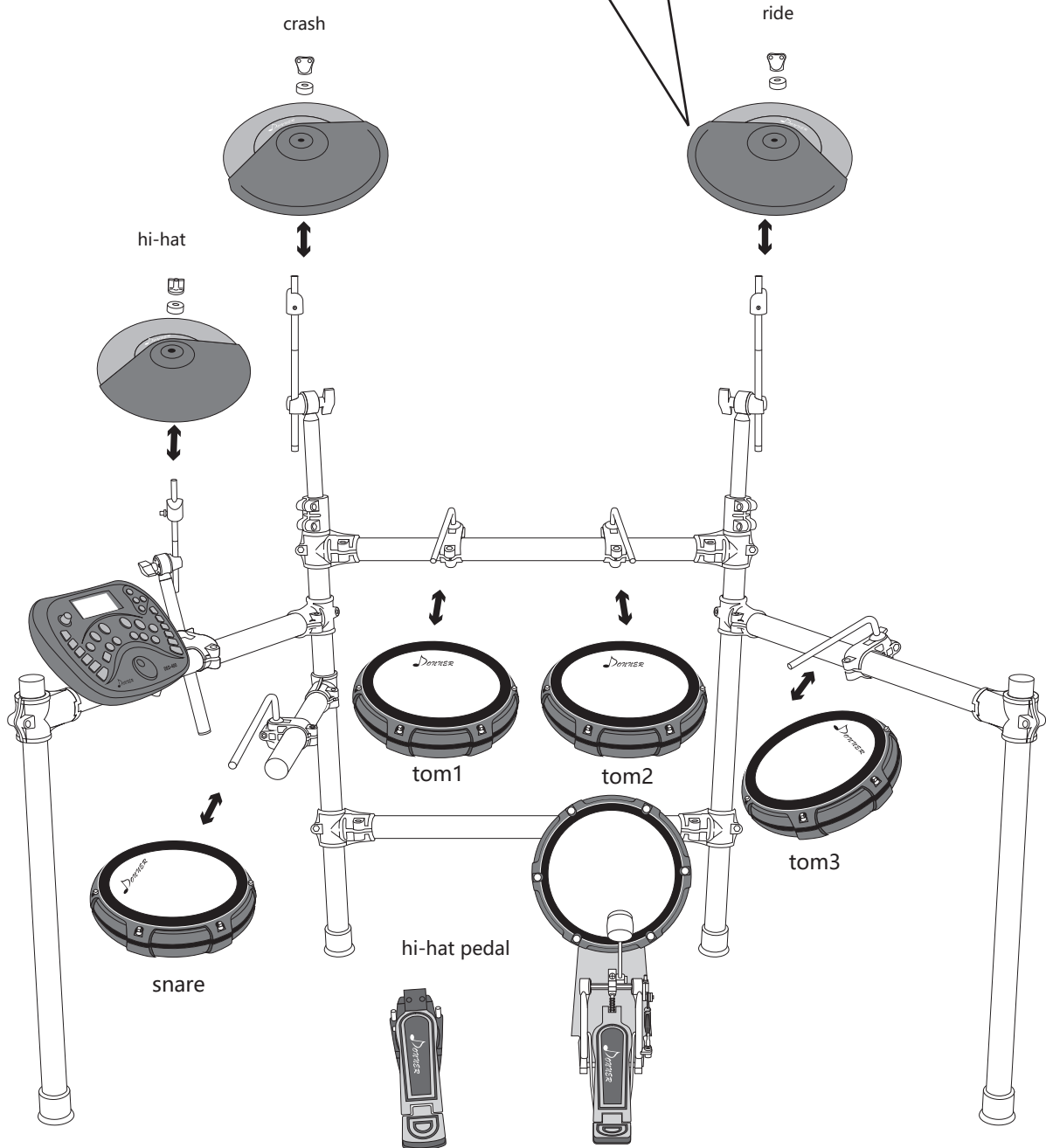

Cymbal Pedal Placement Drum Pedal Placement

简体中文

ENGLISH



# INSTALLATION GUIDE

## 06

### Kick drum installation

- During installation, tighten the screws and be careful not to pinch your finger!

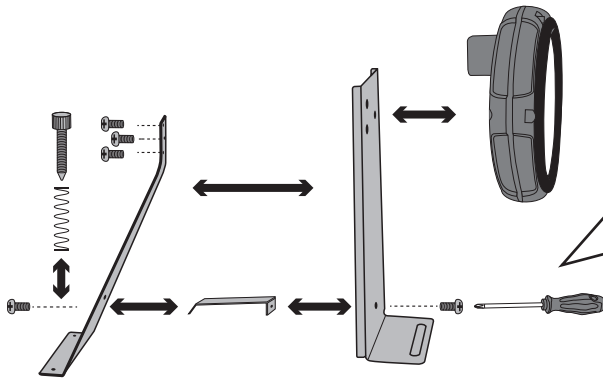

Use screwdriver to lock the kick drum, fixing parts and supporting parts with 5 small screws according to the figure. Then insert two springs into two anti-skid screws, lock in the bottom of the support until it is against the ground.

## 07

### Install hammer stick

- Tighten the screw to avoid loosening.

Insert the hammer rod into the round hole according to the figure, rotate the wool hammer head to align it with the drum face, and tighten it with the drum key.

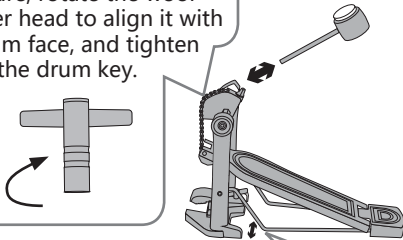

Insert the fixed iron bar into the hole position according to the figure.

## 08

### Kick drum and pedal fixation

- Bottom drum and pedal should be fixed and tightened to avoid falling off.

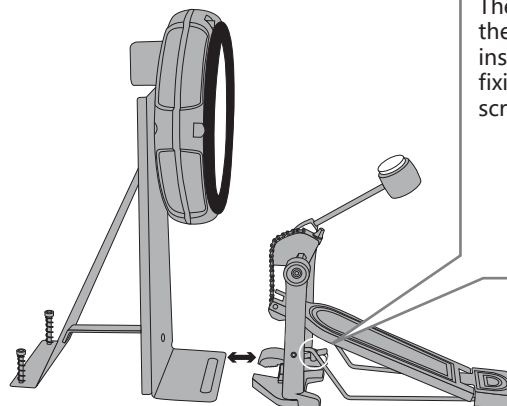

The protruding edge of the bottom drum is inserted into the pedal fixing clamp and the screw is tightened.

## 09

### Insert Connection Line

- Please insert the connecting wire in place to avoid bad contact and insert it correctly follow the diagram.

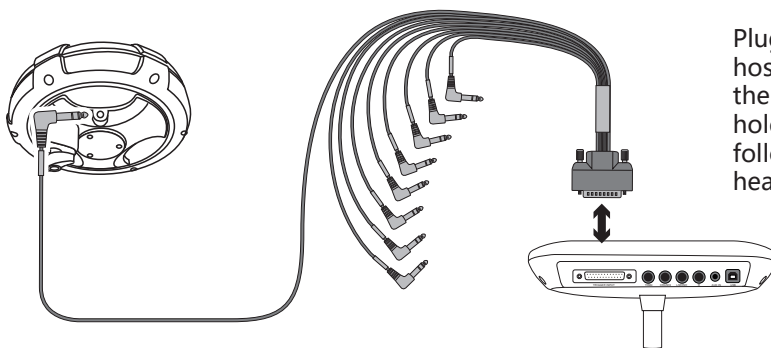

Plug the parallel plug into the host box according to the figure, then insert the corresponding hole position of the hitting part follow the English label of the head of the connecting line.



# Host box socket diagram

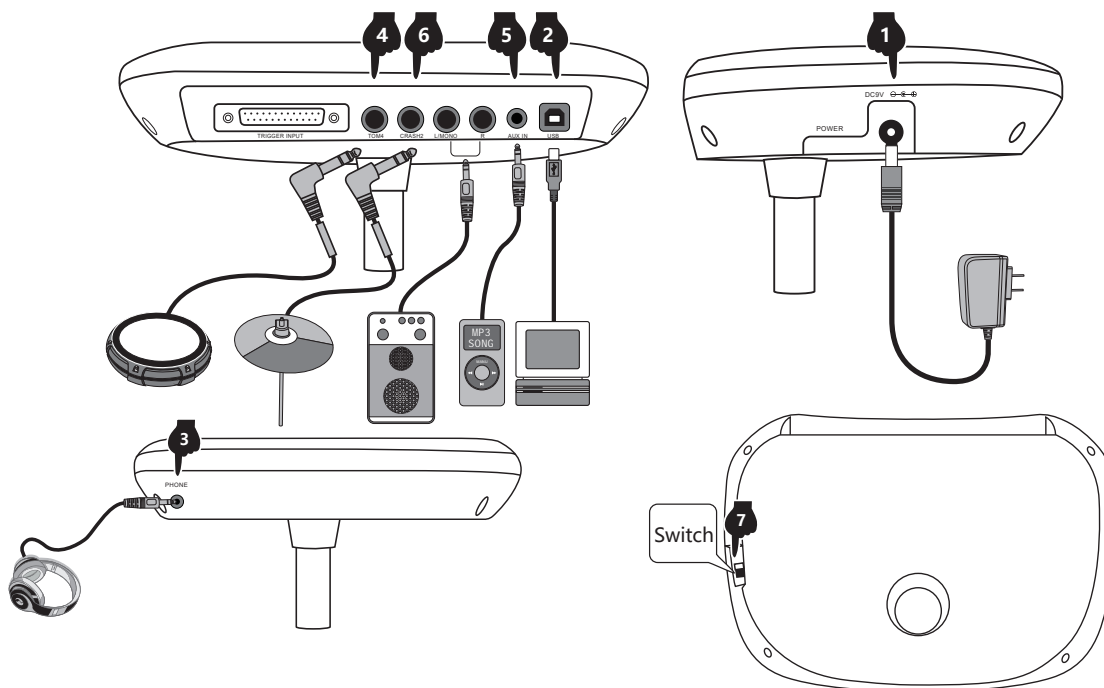

## 1 Power cord connection

1. Plug in the power cord as shown in the diagram, one end into the power port of the drum box, and the other end into a 100-240V household power outlet (Figure 1)
2. When the product is not used for a long time, please unplug the power cord and store it properly.

## 2 USB MIDI Socket

Use the MIDI USB interface of the electronic drums to connect and interact with music devices with MIDI.

1. You can learn or perform, compose, store, and other functional operations with the software pre-installed on your computer or tablet. (Figure 2)
2. When connected to a computer or tablet, the audio output on the device needs to be connected to the audio input jack on the drum host box in order to synchronize the sound on the device. (Figure 5)

## 3 Headphone jack

Connecting headphones allows you to monitor changes in detail while playing, and does not disturb others when playing without a speaker connected. (Figure 3)

## 4 Drum tray expansion jack

Audio output jack can be connected to external active speakers (need special drum speakers), and large audio equipment. (Figure 4)

## 5 Audio input jack

The audio input jack allows you to connect an external audio source to the drum host box for playback (e.g. MP3. linear audio signal input for cell phones, etc.). (Figure 5)

## 6 Cymbal expansion jack

This jack allows you to add a cymbal for easy expansion. (Figure 6)

## 7 Power Switch

The power can be turned on and off. (Figure 7)

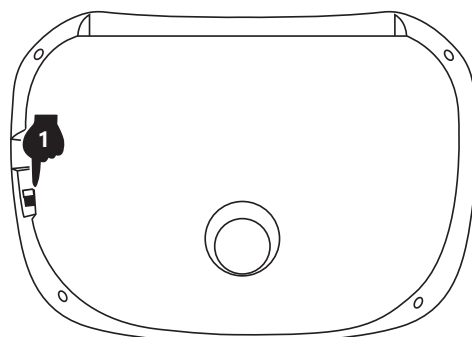
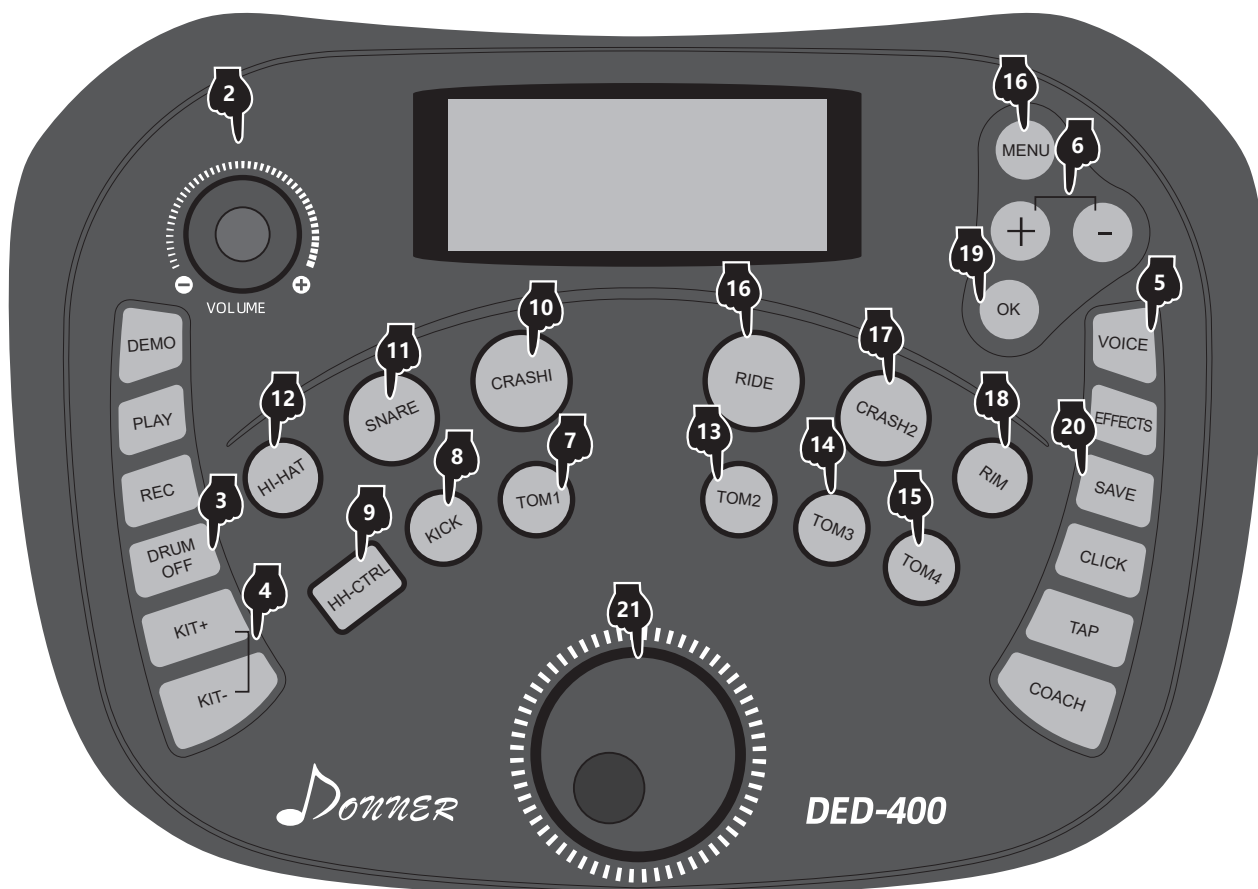

## 1 Start power

1. Press the "power" switch to the on position to enter the playing state. (Figure 1)
2. Please turn off the power when not in use for a while.

- This product processor chip is complex, similar to the computer system, sometimes there is no response, please turn off the power switch and then turn it on again can work normally.

## 2 Volume adjustment

Use the "Volume +/-" button to increase or decrease the total volume, please adjust the volume to a satisfactory position. (Figure 2)



# Operation Guide

## 3 Drum set selection

1. Power on the default drum set to select DRUM KIT 01 (Figure 3) to rotate the selection wheel to select a drum set, or use the KIT <+> <-> (Figure 4) button on the lower left to select a drum set plus or minus (you can use this button for drum set selection in any state), see the drum set table (01-25) for details on preset drum sets.
2. Press the <VOICE> button (Figure 5), then press <+> <-> at the top right (Figure 6) (select the type of drum you want to edit: Kick (bass drum), Snare (snare drum), Tom1-4 (toms), Crash1-2 (hang cymbal), Ride (jingle cymbal), Hat (stomp cymbal), use the encoder, freely configure your favorite drum set with different drum tones, and press the <OK> button to return to the upper menu (refer to Figure 7~Figure 19)

## 4 User-defined drum sets

1. User Kite selects a group by pressing the <Voice> button or press the <Menu> button to select 1-VOICE and press the <OK> button to enter the tone editing mode (Figure 5, Figure 16, Figure 19) after user-defined a total of 25 groups (26-50).
2. Press the (+ -) button to select the type of drum you want to mark, and turn the data wheel below to select it. (Figure 6)
3. Press the <SAVE> button, the indicator light will start flashing and save successfully when the flashing is finished. (Figure 20)

## 5 鼓盘敲击

This product with double trigger induction, so that the percussion sound closer to the acoustic drum effect.

1. "Snare drum" can hit the drum surface and drum edge.
  2. "Hanging cymbal" and "jingling cymbal" can hit the surface and edge of the cymbal, and pinch the edge of the cymbal with fingers to make the sound.
  3. The sound of the cymbal will be changed by different combinations of "cymbal pads" and "cymbal pedal".
- OpenHat": Hit the cymbal surface alone.
  - CloseHat": Depress the pedal and keep it closed, while hitting the cymbal side of the pedal.
  - Pedal": Depress the pedal alone without hitting the cymbal face.

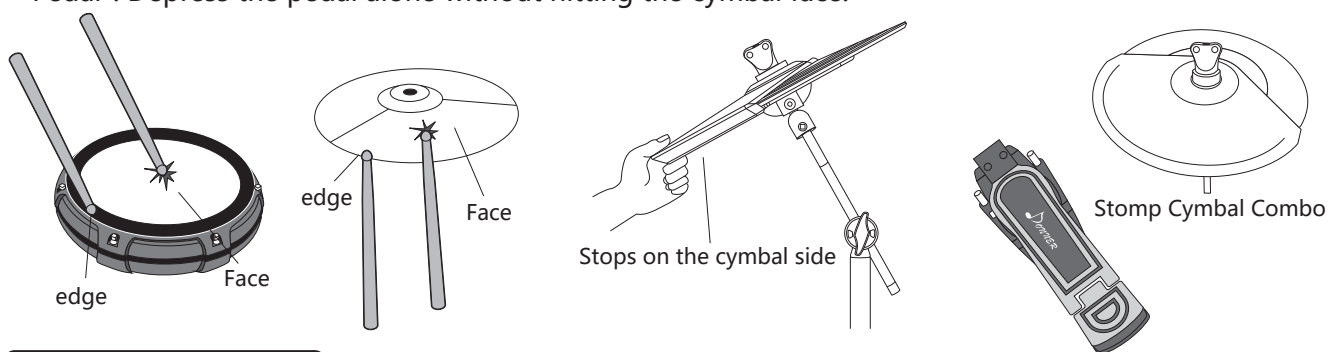

## 6 Menu Button

- 1, press <Menu> button lights up to enter the menu interface, and then press <+> <-> below to select the sub-menu you want to adjust: a total of 1-VOICE (tone), 2-PAD SET (drum set), 3-CLICK (metronome), 4-EFX SET (reverb settings) four sub-menus. (Figure 16, Figure 6)
2. After selecting the desired submenu, press <OK> below to enter the submenu adjustment. (Figure 19)
3. Turn the coding wheel to adjust the parameters, and press <OK> key to confirm after the adjustment to return to the upper menu. (Figure 21)



## 7 Drum pan parameter adjustment

- 1、 Press the <Menu> button, then select 2-PAD SET to enter the drum pan parameter adjustment interface. (Figure A)
- 2、 Tap the drum pad you want to adjust, then press <+> <-> to select the pad parameter you want to adjust.  
 Pad Sen (drum surface sensitivity 1-6 the smaller the number the higher the sensitivity)  
 Rim Sen (drum side sensitivity)  
 HH.L (Stomp cymbal sensitivity 1-3)  
 HH.S (Stomp cymbal speed 1-3)  
 Threshold (Trigger Threshold 1-32)  
 Xtalk (crosstalk threshold 1-32)  
 MaskS Time (Masking Time 1-32)  
 Curve (curve setting LINEAR/LOG/LOUD)  
 Volume (drum pan volume 0-127)  
 Pan (drum pan sound direction 0-127, 64-bit center position)
- 3、 Use the encoder to adjust the drum pan parameters you want to edit by pressing <OK> key. (Figure B)
- 4、 Press <SAVE> to save the current setting parameters. (Figure D)

## 8 Song selection

- 1、 Press the <DEMO> button at the top left, the interface will display Song 01 and enter the song mode. (Figure E)
- 2、 Press <PLAY> to play the song, and press again to pause. (Figure F)
- 3、 Turn the data wheel to select the song you want to play.
- 4、 Press <Drum OFF> in the middle of playing the song, it will turn off the drum sound of the song, and only play the instrumental accompaniment part of the song. Press again to resume the original playback. (Figure G)



# Operation Guide

## 9 Recording

1. Press the left <REC> button, the indicator light will be on to enter the recording mode. (Figure G)
2. You can use the button to select which group you want to record the sound in total. (1-10 recording groups)
3. Tap the drum surface to record the drum sound, 3 seconds without tapping will automatically stop recording, or in this state directly press the <PLAY> button to play the recording just now. (Figure F)
4. Users can record a total of 10 different recordings, select the number of the recording you want to play in the recording state.

## 10 Effectors

1. press the right <EFFECTS> button, the indicator light is always on, at this time, it means open the effector. (Figure I)
2. press the <EFFECT> button again to close the effector.
3. press <Menu> button to select 4-EFX SET press <OK> button to enter the adjustment of the effector parameters. (Figure A, Figure C)
4. press <+> button to select the parameters to be adjusted: (Figure 2)  
Rev Type (reverb type 1-5)  
Rev Level (reverb depth 0-127)  
High EQ (high frequency equalization 0-127)  
Bass EQ (low-frequency equalization 0-127)
5. turn the data wheel to adjust the selected parameters, and then press <OK> key to confirm to return to the upper menu, if you want to continue to use the next time you can press <SAVE> button to save (Figure D)

## 10 Metronome

1. Press the right <CLICK> button, the indicator light will be on for a long time and the metronome will sound. (Figure J)
2. Press the <CLICK> button again, the light goes off and the metronome stops.
3. Press <Menu> button to select 3-CLICK and press <OK> button for metronome parameters. (Figure A, Figure C)
4. Press <+> button to select the parameter to be adjusted: (Figure B)  
Rhythm (beat type 1-4)  
Beat (beat number 1-9)  
Volume (metronome volume 0-127)  
Tempo (beat speed 30-250)
5. Turn the data wheel to adjust the selected parameters, then press <OK> to confirm to return to the upper menu, if you want to continue to use next time you can press <SAVE> button to save. (Figure K, Figure C, Figure D)

## 11 TAP beat measuring function

1. According to the current music speed press the right <TAP> button, the indicator will follow the press to light up and go out
2. After multiple presses (6 times) the screen will display the current speed of Tempo according to the time interval between presses
3. the speed range is: 30-255, if the speed range is overflowing, you need to pause and press the <TAP> button, wait a few seconds and then press the <TAP> button again, it will restart the speed measurement.



# Operation Guide

## 12 Exercise function

1. Press the right <COACH> button, the indicator light is always on, enter the practice mode, the screen shows the exercise type.  
 TIME CHECK (strike time value practice mode)  
 QUIETCONUT (silent practice mode)  
 AUTO TEMPO (automatic acceleration and deceleration practice mode)
  2. press <+> button to select the desired practice mode and then press <OK> key to enter the mode, press <OK> key again to return to the upper menu.
  3. Use the encoder to adjust to the parameters you want to practice, after setting, press <CLICK> button to start, hit the drum pan or press the tone box Press the tone button in the middle of the box to start practicing.
- TIME CHECK (percussion time practice mode)  
 After entering this mode, you can press the <+> button to select the option you want to set  
 ①Rhythm (time value type)  
 ②Beat 04 (number of beats)  
 ③Tempo 120 (beat speed)

Exercise instructions :

Notes = 110 (beat type and tempo)  
 ----% ( Accuracy )  
 Solw      Good      Fast ( Accuracy )

- QUIETCONUT(Silent practice mode )  
 After entering this mode, you can press the <+> button to select the option you want to set

- ①Count      04 ( Number of bars with sound )
- ②Mute      04 ( Number of bars of mute )
- ③Rhythm      ( Time value type )
- ④Beat      04 ( Number of beats 1-9 )
- ⑤Tempo    120 ( Beat speed 30-250 )

Exercise description:

1-2      Notes = 110 (beat type and tempo)  
 Ready ...(Mute the previous bar to prepare tips ) ----% ( Accuracy )

- AUTO TEMPO ( Automatic acceleration and deceleration practice mode )  
 After entering this mode, you can press the <+> button to select the option you want to set  
 ①Rate 04      ( The number of beats per automatic speed increase or decrease )  
 ②StartTemp 60 ( Metronome start speed 30-250 )  
 ③EndTemp      ( Metronome start speed 30-250 )  
 ④Rhythm      ( Time value type1-4 )  
 ⑤Beat 04      ( Number of beats1-9 )

Exercise description:

1-3      Notes = 110 (beat type and tempo)  
 ----% ( Accuracy )  
 60-120 Variable speed start and end speed



## 13 Save/Reset

- 1、 Short press the <SAVE> button, the indicator light will start flashing, and the save will be successful when the flashing is finished.
- 2、 Press and hold the <SAVE> button to restore the factory settings and jump back to the power-on screen. (Figure 4)

## 14 Extended Interface

There are two expansion interfaces, CRASH2 and TOM4. (Figure 5, Figure 6)

## 16 Drum button

- 1、 All drums can be emitted by push-button buttons
- 2、 Edge RIM compound press can make side strike: such as military drum side press SNARE and then press RIM key can make military drum side strike sound.



## Drum Tone

- 1 Funk Kick
- 2 Popular Kick
- 3 Pop Kick
- 4 Punk Kick
- 5 Studio Kick
- 6 Session Kick
- 7 Metal mach Kick
- 8 Metal Kick
- 9 Speed Metal Kick
- 10 Hard Rock Kick
- 11 Rock Kick
- 12 Old School Kick
- 13 Standard Kick
- 14 Fucky Kick
- 15 Modern Kick
- 16 Grunge Kick
- 17 Jazz Kick
- 18 Blues Kick
- 19 Blues Rock Kick
- 20 PopRock Kick
- 21 Power Kick
- 22 Slam Kick
- 23 Synth Gaze Kick
- 24 Morrh Kick
- 25 Chinese Kick

### Snare

- 26 Funk Snare
- 27 Popular Snare
- 28 Pop Snare
- 29 Punk Snare
- 30 Studio Snare
- 31 Session Snare
- 32 Metal mach Snare
- 33 Metal Snare
- 34 Speed Metal Snare
- 35 Hard Rock Snare
- 36 Rock Snare
- 37 Old School Snare
- 38 Standard Snare
- 39 Fucky Snare
- 40 Modern Snare
- 41 Grunge Snare
- 42 Jazz Snare
- 43 Blues Snare
- 44 Blues Rock Snare
- 45 PopRock Snare
- 46 Power Snare
- 47 Slam Snare
- 48 Synth Gaze Snare

- 49 Morrh Snare
- 50 Chinese Snare
- 51 Funk Snare Rim
- 52 Popular Snare Rim
- 53 Pop Snare Rim
- 54 Punk Snare Rim
- 55 Studio Snare Rim
- 56 Session Snare Rim
- 57 Metal mach Snare Rim
- 58 Metal Snare Rim
- 59 Speed Metal Snare Rim
- 60 Hard Rock Snare Rim
- 61 Rock Snare Rim
- 62 Old School Snare Rim
- 63 Standard Snare Rim
- 64 Fucky Snare Rim
- 65 Modern Snare Rim
- 66 Grunge Snare Rim
- 67 Jazz Snare Rim
- 68 Blues Snare Rim
- 69 Blues Rock Snare Rim
- 70 PopRock Snare Rim
- 71 Power Snare Rim
- 72 Slam Snare Rim
- 73 Synth Gaze Snare Rim
- 74 Morrh Snare Rim
- 75 Chinese Snare Rim

### Tom

- 76 Funk Tom1
- 77 Popular Tom1
- 78 Pop Tom1
- 79 Punk Tom1
- 80 Studio Tom1
- 81 Session Tom1
- 82 Metal mach Tom1
- 83 Metal Tom1
- 84 Speed Metal Tom1
- 85 Hard Rock Tom1
- 86 Rock Tom1
- 87 Old School Tom1
- 88 Standard Tom1
- 89 Fucky Tom1
- 90 Modern Tom1
- 91 Grunge Tom1
- 92 Jazz Tom1
- 93 Blues Tom1
- 94 Blues Rock Tom1
- 95 PopRock Tom1
- 96 Power Tom1

- 97 Slam Tom1
- 98 Synth Gaze Tom1
- 99 Morrh Tom1
- 100 Chinese Tom1
- 101 Funk Tom2
- 102 Popular Tom2
- 103 Pop Tom2
- 104 Punk Tom2
- 105 Studio Tom2
- 106 Session Tom2
- 107 Metal mach Tom2
- 108 Metal Tom2
- 109 Speed Metal Tom2
- 110 Hard Rock Tom2
- 111 Rock Tom2
- 112 Old School Tom2
- 113 Standard Tom2
- 114 Fucky Tom2
- 115 Modern Tom2
- 116 Grunge Tom2
- 117 Jazz Tom2
- 118 Blues Tom2
- 119 Blues Rock Tom2
- 120 PopRock Tom2
- 121 Power Tom2
- 122 Slam Tom2
- 123 Synth Gaze Tom2
- 124 Morrh Tom2
- 125 Chinese Tom2
- 126 Funk Tom3
- 127 Popular Tom3
- 128 Pop Tom3
- 129 Punk Tom3
- 130 Studio Tom3
- 131 Session Tom3
- 132 Metal mach Tom3
- 133 Metal Tom3
- 134 Speed Metal Tom3
- 135 Hard Rock Tom3
- 136 Rock Tom3
- 137 Old School Tom3
- 138 Standard Tom3
- 139 Fucky Tom3
- 140 Modern Tom3
- 141 Grunge Tom3
- 142 Jazz Tom3
- 143 Blues Tom3
- 144 Blues Rock Tom3
- 145 PopRock Tom3
- 146 Power Tom3



- 147 Slam Tom3
- 148 Synth Gaze Tom3
- 149 Morror Tom3
- 150 Chinese Tom3
- 151 Funk Tom4
- 152 Popular Tom4
- 153 Pop Tom4
- 154 Punk Tom4
- 155 Studio Tom4
- 156 Session Tom4
- 157 Metal mach Tom4
- 158 Metal Tom4
- 159 Speed Metal Tom4
- 160 Hard Rock Tom4
- 161 Rock Tom4
- 162 Old School Tom4
- 163 Standard Tom4
- 164 Fucky Tom4
- 165 Modern Tom4
- 166 Grunge Tom4
- 167 Jazz Tom4
- 168 Blues Tom4
- 169 Blues Rock Tom4
- 170 PopRock Tom4
- 171 Power Tom4
- 172 Slam Tom4
- 173 Synth Gaze Tom4
- 174 Morror Tom4
- 175 Chinese Tom4

## Crash

- 176 Funk Crash1
- 177 Popular Crash1
- 178 Pop Crash1
- 179 Punk Crash1
- 180 Studio Crash1
- 181 Session Crash1
- 182 Metal mach Crash1
- 183 Metal Crash1
- 184 Speed Metal Crash1
- 185 Hard Rock Crash1
- 186 Rock Crash1
- 187 Old School Crash1
- 188 Standard Crash1
- 189 Fucky Crash1
- 190 Modern Crash1
- 191 Grunge Crash1
- 192 Jazz Crash1
- 193 Blues Crash1
- 194 Blues Rock Crash1
- 195 PopRock Crash1
- 196 Power Crash1
- 197 Slam Crash1

- 198 Synth Gaze Crash1
- 199 Morror Crash1
- 200 Chinese Crash1
- 201 Funk Crash1 Rim
- 202 Popular Crash1 Rim
- 203 Pop Crash1 Rim
- 204 Punk Crash1 Rim
- 205 Studio Crash1 Rim
- 206 Session Crash1 Rim
- 207 Metal mach Crash1 Rim
- 208 Metal Crash1 Rim
- 209 Speed Metal Crash1 Rim
- 210 Hard Rock Crash1 Rim
- 211 Rock Crash1 Rim
- 212 Old School Crash1 Rim
- 213 Standard Crash1 Rim
- 214 Fucky Crash1 Rim
- 215 Modern Crash1 Rim
- 216 Grunge Crash1 Rim
- 217 Jazz Crash1 Rim
- 218 Blues Crash1 Rim
- 219 Blues Rock Crash1 Rim
- 220 PopRock Crash1 Rim
- 221 Power Crash1 Rim
- 222 Slam Crash1 Rim
- 223 Synth Gaze Crash1 Rim
- 224 Morror Crash1 Rim
- 225 Chinese Crash1 Rim
- 226 Funk Crash2
- 227 Popular Crash2
- 228 Pop Crash2
- 229 Punk Crash2
- 230 Studio Crash2
- 231 Session Crash2
- 232 Metal mach Crash2
- 233 Metal Crash2
- 234 Speed Metal Crash2
- 235 Hard Rock Crash2
- 236 Rock Crash2
- 237 Old School Crash2
- 238 Standard Crash2
- 239 Fucky Crash2
- 240 Modern Crash2
- 241 Grunge Crash2
- 242 Jazz Crash2
- 243 Blues Crash2
- 244 Blues Rock Crash2
- 245 PopRock Crash2
- 246 Power Crash2
- 247 Slam Crash2
- 248 Synth Gaze Crash2
- 249 Morror Crash2
- 250 Chinese Crash2

- 251 Funk Crash2 Rim
- 252 Popular Crash2 Rim
- 253 Pop Crash2 Rim
- 254 Punk Crash2 Rim
- 255 Studio Crash2 Rim
- 256 Session Crash2 Rim
- 257 Metal mach Crash2 Rim
- 258 Metal Crash2 Rim
- 259 Speed Metal Crash2 Rim
- 260 Hard Rock Crash2 Rim
- 261 Rock Crash2 Rim
- 262 Old School Crash2 Rim
- 263 Standard Crash2 Rim
- 264 Fucky Crash2 Rim
- 265 Modern Crash2 Rim
- 266 Grunge Crash2 Rim
- 267 Jazz Crash2 Rim
- 268 Blues Crash2 Rim
- 269 Blues Rock Crash2 Rim
- 270 PopRock Crash2 Rim
- 271 Power Crash2 Rim
- 272 Slam Crash2 Rim
- 273 Synth Gaze Crash2 Rim
- 274 Morror Crash2 Rim
- 275 Chinese Crash2 Rim

## Ride

- 276 Funk Ride
- 277 Popular Ride
- 278 Pop Ride
- 279 Punk Ride
- 280 Studio Ride
- 281 Session Ride
- 282 Metal mach Ride
- 283 Metal Ride
- 284 Speed Metal Ride
- 285 Hard Rock Ride
- 286 Rock Ride
- 287 Old School Ride
- 288 Standard Ride
- 289 Fucky Ride
- 290 Modern Ride
- 291 Grunge Ride
- 292 Jazz Ride
- 293 Blues Ride
- 294 Blues Rock Ride
- 295 PopRock Ride
- 296 Power Ride
- 297 Slam Ride
- 298 Synth Gaze Ride
- 299 Morror Ride
- 300 Chinese Ride
- 301 Funk Ride Rim



# Appendix

- |                          |                              |                              |
|--------------------------|------------------------------|------------------------------|
| 302 Popular Ride Rim     | 334 Speed Metal Hi-Hat Open  | 368 Blues Hi-Hat Close       |
| 303 Pop Ride Rim         | 335 Hard Rock Hi-Hat Open    | 369 Blues Rock Hi-Hat Close  |
| 304 Punk Ride Rim        | 336 Rock Hi-Hat Open         | 370 PopRock Hi-Hat Close     |
| 305 Studio Ride Rim      | 337 Old School Hi-Hat Open   | 371 Power Hi-Hat Close       |
| 306 Session Ride Rim     | 338 Standard Hi-Hat Open     | 372 Slam Hi-Hat Close        |
| 307 Metal mach Ride Rim  | 339 Fucky Hi-Hat Open        | 373 Synth Gaze Hi-Hat Close  |
| 308 Metal Ride Rim       | 340 Modern Hi-Hat Open       | 374 Morror Hi-Hat Close      |
| 309 Speed Metal Ride Rim | 341 Grunge Hi-Hat Open       | 375 Chinese Hi-Hat Close     |
| 310 Hard Rock Ride Rim   | 342 Jazz Hi-Hat Open         | 376 Funk Hi-Hat Pedal        |
| 311 Rock Ride Rim        | 343 Blues Hi-Hat Open        | 377 Popular Hi-Hat Pedal     |
| 312 Old School Ride Rim  | 344 Blues Rock Hi-Hat Open   | 378 Pop Hi-Hat Pedal         |
| 313 Standard Ride Rim    | 345 PopRock Hi-Hat Open      | 379 Punk Hi-Hat Pedal        |
| 314 Fucky Ride Rim       | 346 Power Hi-Hat Open        | 380 Studio Hi-Hat Pedal      |
| 315 Modern Ride Rim      | 347 Slam Hi-Hat Open         | 381 Session Hi-Hat Pedal     |
| 316 Grunge Ride Rim      | 348 Synth Gaze Hi-Hat Open   | 382 Metal mach Hi-Hat Pedal  |
| 317 Jazz Ride Rim        | 349 Morror Hi-Hat Open       | 383 Metal Hi-Hat Pedal       |
| 318 Blues Ride Rim       | 350 Chinese Hi-Hat Open      | 384 Speed Metal Hi-Hat Pedal |
| 319 Blues Rock Ride Rim  | 351 Funk Hi-Hat Close        | 385 Hard Rock Hi-Hat Pedal   |
| 320 PopRock Ride Rim     | 352 Popular Hi-Hat Close     | 386 Rock Hi-Hat Pedal        |
| 321 Power Ride Rim       | 353 Pop Hi-Hat Close         | 387 Old School Hi-Hat Pedal  |
| 322 Slam Ride Rim        | 354 Punk Hi-Hat Close        | 388 Standard Hi-Hat Pedal    |
| 323 Synth Gaze Ride Rim  | 355 Studio Hi-Hat Close      | 389 Fucky Hi-Hat Pedal       |
| 324 Morror Ride Rim      | 356 Session Hi-Hat Close     | 390 Modern Hi-Hat Pedal      |
| 325 Chinese Ride Rim     | 357 Metal mach Hi-Hat Close  | 391 Grunge Hi-Hat Pedal      |
|                          | 358 Metal Hi-Hat Close       | 392 Jazz Hi-Hat Pedal        |
|                          | 359 Speed Metal Hi-Hat Close | 393 Blues Hi-Hat Pedal       |
|                          | 360 Hard Rock Hi-Hat Close   | 394 Blues Rock Hi-Hat Pedal  |
|                          | 361 Rock Hi-Hat Close        | 395 PopRock Hi-Hat Pedal     |
|                          | 362 Old School Hi-Hat Close  | 396 Power Hi-Hat Pedal       |
|                          | 363 Standard Hi-Hat Close    | 397 Slam Hi-Hat Pedal        |
|                          | 364 Fucky Hi-Hat Close       | 398 Synth Gaze Hi-Hat Pedal  |
|                          | 365 Modern Hi-Hat Close      | 399 Morror Hi-Hat Pedal      |
|                          | 366 Grunge Hi-Hat Close      | 400 Chinese Hi-Hat Pedal     |
|                          | 367 Jazz Hi-Hat Close        |                              |

## Hi-Hat

## Preset Drum Kits

- |             |                |               |               |               |
|-------------|----------------|---------------|---------------|---------------|
| 01 Standard | 06 Session     | 11 Rock       | 16 Grunge     | 21 Power      |
| 02 Popular  | 07 Metal mach  | 12 Old School | 17 Jazz       | 22 Slam       |
| 03 Pop      | 08 Metal       | 13 Funk       | 18 Blues      | 23 Synth Gaze |
| 04 Punk     | 09 Speed Metal | 14 Fucky      | 19 Blues Rock | 24 Morror     |
| 05 Studio   | 10 Hard Rock   | 15 Modern     | 20 PopRock    | 25 Chinese    |

## User-defined drum sets

- |              |               |               |               |               |
|--------------|---------------|---------------|---------------|---------------|
| 26 User Kit1 | 31 User Kit6  | 36 User Kit11 | 41 User Kit16 | 46 User Kit21 |
| 27 User Kit2 | 32 User Kit7  | 37 User Kit12 | 42 User Kit17 | 47 User Kit22 |
| 28 User Kit3 | 33 User Kit8  | 38 User Kit13 | 43 User Kit18 | 48 User Kit23 |
| 29 User Kit4 | 34 User Kit9  | 39 User Kit14 | 44 User Kit19 | 49 User Kit24 |
| 30 User Kit5 | 35 User Kit10 | 40 User Kit15 | 45 User Kit20 | 50 User Kit25 |

## Song List

- |         |         |         |         |         |
|---------|---------|---------|---------|---------|
| DEMO 01 | DEMO 11 | DEMO 21 | DEMO 31 | DEMO 41 |
| DEMO 02 | DEMO 12 | DEMO 22 | DEMO 32 | DEMO 42 |
| DEMO 03 | DEMO 13 | DEMO 23 | DEMO 33 | DEMO 43 |
| DEMO 04 | DEMO 14 | DEMO 24 | DEMO 34 | DEMO 44 |
| DEMO 05 | DEMO 15 | DEMO 25 | DEMO 35 | DEMO 45 |
| DEMO 06 | DEMO 16 | DEMO 26 | DEMO 36 | DEMO 46 |
| DEMO 07 | DEMO 17 | DEMO 27 | DEMO 37 | DEMO 47 |
| DEMO 08 | DEMO 18 | DEMO 28 | DEMO 38 | DEMO 48 |
| DEMO 09 | DEMO 19 | DEMO 29 | DEMO 39 | DEMO 49 |
| DEMO 10 | DEMO 20 | DEMO 30 | DEMO 40 | DEMO 50 |



## PRODUCT MAINTENANCE

Careful maintenance and protection of the product, to extend the service life of the product, reduce the fault has a very important role.

### **1 AVOID HEATING, DAMPNES OR DIRECT SUNLIGHT**

Do not over expose the product to direct sunlight, or place it near air conditioning or extremely hot place.

### **2 DO NOT USE NEAR THE TV OR RADIO**

This product may cause video or audio interference to the reception of TV and radio. If this happens, the product should be removed from the TV or radio.

### **3 NO DILUENTS OR SIMILAR CHEMICALS SHOULD BE USED FOR CLEANING**

Clean the product with a soft cloth wetted with weak water solution and neutral detergent. Soak the cloth in a solution and wring it dry until it approaches drying.

### **4 DO NOT SHAKE, AVOID COLLISION**

When moving, the product should be handled carefully and lightly. Violent vibration and collision are strictly prohibited in order to avoid damage to the shell or internal electronic components.



# SAFETY PRECAUTIONS

## POWER SUPPLY

This product can be powered by standard indoor wall sockets. Please only use the power cord specified in this product. When not in use, please turn off the power supply. When not in use for a long time, pull out the power cord and keep it properly.

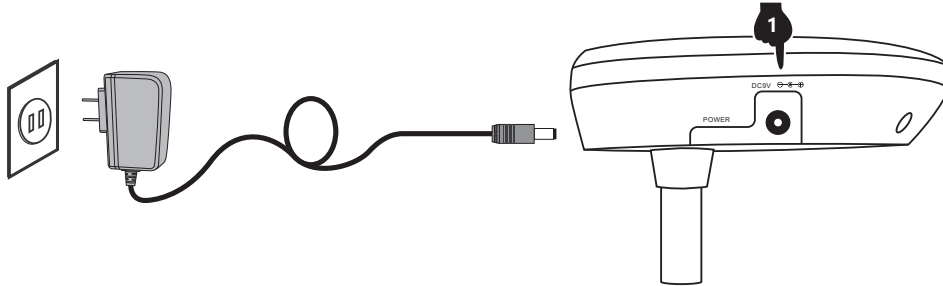

## SIGN

To ensure that you use this product safely and correctly, to prevent harm to users and others and financial damage, this manual and products are marked with a series of safety signs. The various signs and their meanings are as follows:

### **WARNING**

This sign indicates that there is a potential risk of death or serious injury if this mark is ignored and the product is mishandled.

### **BE CAREFUL**

This sign indicates that there is a potential danger of injury to personnel or other financial damage if this sign is ignored and the product is operated incorrectly.

## EXAMPLE OF LOGO



This triangle sign ( $\Delta$ ) indicates what users should pay attention to. (The left example is careful shocks)



A circular sign ( $\odot$ ) with an oblique line indicates prohibitions. The icons in or beside the logo indicate the contents specifically prohibited. (The example on the left is no disassembly)



The round black bottom sign ( $\bullet$ ) indicates what must be observed. The diagrams in this sign indicate the contents of the specific matters that must be observed. (The example on the left is that the power plug must be pulled out of the socket)



# SAFETY PRECAUTIONS

## ⚠️ WARNING

### Smoke, odor, overheating

When the product smokes, smells or overheats, there is a danger of fire and electric shock when it is used continually. In case of the above situation, the following operations should be performed immediately:

1. Turn off the power supply.
2. Pull the plug out of the power outlet.
3. Contact your dealer.

### Power cord

1. The improper use of power cord may cause fire and electric shock. The following precautions must be observed:

- The special power cord designated for this product must be used.
- The AC power supply with output voltage within the rated voltage range for household use must be used.
- Do not overload power sockets and extension lines.



2. The improper treatment of power line will lead to its damage or breakage, which will cause fire and electric shock hazards. The following precautions must be observed:

- Do not place or heat heavy objects on power lines.
- Do not attempt to alter or bend the power cord too much.
- Do not twist or pull the power cord.
- If the power cord or plug is damaged, please replace the same type of power cord.



3. Do not touch the power cord and plug with wet hands, otherwise there is a danger of electric shock.



4. Please use the power cord where the water will not splash. Water is in danger of causing fire and electric shock.



5. Never place vases or any other container containing water on this product. Water is dangerous of causing fire and electric shock.



6. Do not allow minors to unplug and touch power lines or connection boards. Minors have no common sense of electricity safety, which may cause electric shock.



## ⚠️ BE CAREFUL

The improper use of power cord may cause fire and electric shock. The following precautions must be observed:

- Never put the power cord near the oven or other heat source.
- Do not pull the cable when pulling out of the power socket. The main body of the plug must be grasped.
- The power cord plug must be inserted in the socket to the end.
- Make sure the power supply is off before connecting or disconnecting it.
- When thunderstorms occur or before traveling or other long-term departure, disconnect the power cord from the wall outlet.
- At least once a year, remove the power cord from the wall outlet and clean the dust accumulated around the plug.



### Do not burn this product

Do not put this product in the fire, otherwise it will lead to product combustion and explosion of internal electronic components, which will cause fire and personnel injury.



### Water and foreign bodies

Water, other liquids and (metal sheets, etc.) entering this product are in danger of causing fire and electric shock. In case of the above situation, the following operations shall be performed immediately:

1. Turn off the power supply.
2. If you are using a power cord for power supply, unplug it from the wall outlet.
3. Contact your distributor.



### Disassembly and transformation

Do not disassemble or transform the product in any way, otherwise there is a risk of electric shock, scald or other personal injury. All internal inspection, adjustment and maintenance operations should be entrusted to your distributor.





# SAFETY PRECAUTIONS

## Falling or colliding

If the product falls or is damaged by strong impact, it will be in danger of causing fire and electric shock. In case of the above situation, the following operations shall be performed immediately:



1. Turn off the power supply.
2. If you are using a power cord for power supply, you need to unplug it from the wall outlet.
3. Contact your distributor.

## Plastic bag

Do not let anyone put plastic bags for this product on his head or in his mouth. Otherwise, there is a risk of asphyxia. Families with young children should pay special attention to it.



## Keep a distance from the product and the bracket

Climbing the bracket is dangerous of overturning or damage. Families with young children should pay special attention to it.



## Put

Avoid placing the product on an uneven surface or any other unstable place. Otherwise, it will cause the product to fall down, which will lead to the risk of injury.



## Product Mobility

Before moving this product, you must unplug the power cord plug from the wall outlet and pull out all other cables and connecting wires. Otherwise, it will lead to damage of power or connection wires, resulting in fire and electric shock.



## clean

Before cleaning this product, you must unplug the power cord plug from the wall outlet, otherwise there is a risk of fire and electric shock.



## Jack

The socket of this product can only be connected to the designated equipment and devices. Connecting non-designated equipment or devices is dangerous of causing fire and electric shock.



## Location selection

It should be avoided to place the product in the following places, otherwise there is a risk of fire and electric shock.



- High temperature or dusty places.
- Kitchen or other places with lampblack.
- Where the product is exposed to direct sunlight, or any other place where the product will produce high temperature.

## Volume

Don't play music long and loud. Pay special attention when using headphones. Excessive volume can damage your hearing.



## Heavy

Do not place heavy objects on this product. Otherwise, the top of the product will be overweight, causing the product to overturn or drop objects on it, which will lead to the risk of injury.



## Correct assembly of scaffolds

The incorrect assembly of the bracket may overturn, causing the product to fall off and posing a risk of injury to personnel. Therefore, it must be assembled according to the instructions in the attached installation guide to ensure that the product is properly mounted on its bracket.





# WARRANTY CARD

## Warranty rules

1. Faults arising from normal use of this product can be guaranteed free of charge for \_\_\_\_\_ days from the date of purchase.
2. Failure occurs during the warranty period. This warranty card and shopping ticket must be presented during maintenance.
3. In the following cases, no free warranty will be provided:
  - Damage caused by improper use by users.
  - Fault damage caused by irresistible factors such as fire, flood, earthquake and lightning strike.
  - Failure caused by unauthorized self-disassembly.
4. After exceeding the warranty period, the company is responsible for maintenance, but it needs to charge a cost fee.

**Seller:** \_\_\_\_\_

**Address:** \_\_\_\_\_

**Telephone:** \_\_\_\_\_

## Maintenance record

Date	Maintenance record	Repairman



简体中文

ENGLISH

**Manufacturer:** Guangzhou LanShen Technology Co.

**Address:** Building D, Kengkou Electronic Digital Base, No.9 Huaxi Road, Liwan District, Guangzhou City, Guangdong Province



[www.idonner.com](http://www.idonner.com)  
[www.donnerdeal.com](http://www.donnerdeal.com)