

Getting ready 2

Panel descriptions 2

 Top panel 2

 Side panel and front panel 4

 Bottom panel 4

 Rear panel (connecting your equipment) 5

Turning the power on/off 6

Configuring pads that support digital connection 7

Configuring the hi-hat 8

Basic operations 9

Performance techniques 10

Playing 12

Drum kits and instruments 12

Instrument Expansions 12

Racks and slots 12

Selecting a drum kit 13

 Selecting a drum kit from the list 13

 Loading drum kits from the Instrument Expansions 14

Using the click sound 15

Playing along with a song 15

 Playing along with a song from your smartphone 15

 Playing along with the songs on the V71 16

Registering/recalling your favorite drum kits 17

Recording your performance 17

Customizing a drum kit 18

Editing Instruments (INSTRUMENT) 18

Adjusting the tonal character of the pads or drum kit (EQ/COMP) 19

Editing the mixer (MIXER) 19

Recreating the reverberations of a performance location (AMBIENCE) 20

Adding effects (BUS FX) 20

Editing a drum kit (OTHERS) 21

 Setting the drum kit volume (KIT VOLUME) 21

 Setting the colors for the buttons and dial (KIT COLOR) 21

 Renaming the drum kit (KIT NAME) 21

Importing and playing audio files (USER SAMPLE) 22

 Importing an audio file 22

 Assigning a user sample to an instrument and playing it 22

Configuring the settings 23

Trigger settings 23

 Specify the pad type 23

 Adjusting the sensitivity for individual pads 23

Configuring the Instrument Expansions 24

Backing up data 24

 Formatting an SD card 24

 Backing up to an SD card (SAVE) 25

 Loading backup data from an SD card (LOAD) 25

Making overall settings for the V71 (SETUP) 26

Using this unit with a computer or smartphone app 26

 Configuring the USB driver 27

 Using V71 Editor on your computer 27

Restoring the factory settings 27

Restoring the drum kit to factory settings 28

USING THE UNIT SAFELY 29

IMPORTANT NOTES 30

Printed manuals

- **Quick Start (this document)**
Explains the basics of using this unit.
- **Roland Cloud Connect Setup Guide**
Explains how to register for and connect to Roland Cloud.

PDF manuals (download from Roland website)

- **Reference Manual**
Explains all functions of this unit.
- **Roland Cloud User's Guide**
Explains how to use Roland Cloud in detail.
- **Data List**
Explains the parameters and sounds used in this unit.
- **MIDI Implementation**
Provides detailed information about MIDI messages.

How to get the PDF manuals

1. Visit the following website on your computer or other device.
<https://www.roland.com/manuals/>
2. Choose "V71" as the product name.



Before using this unit, carefully read "USING THE UNIT SAFELY" and "IMPORTANT NOTES" (the leaflet "USING THE UNIT SAFELY" and the Quick Start (p. 29)). After reading, keep the document(s) where it will be available for immediate reference.

Getting ready

Panel descriptions

Top panel

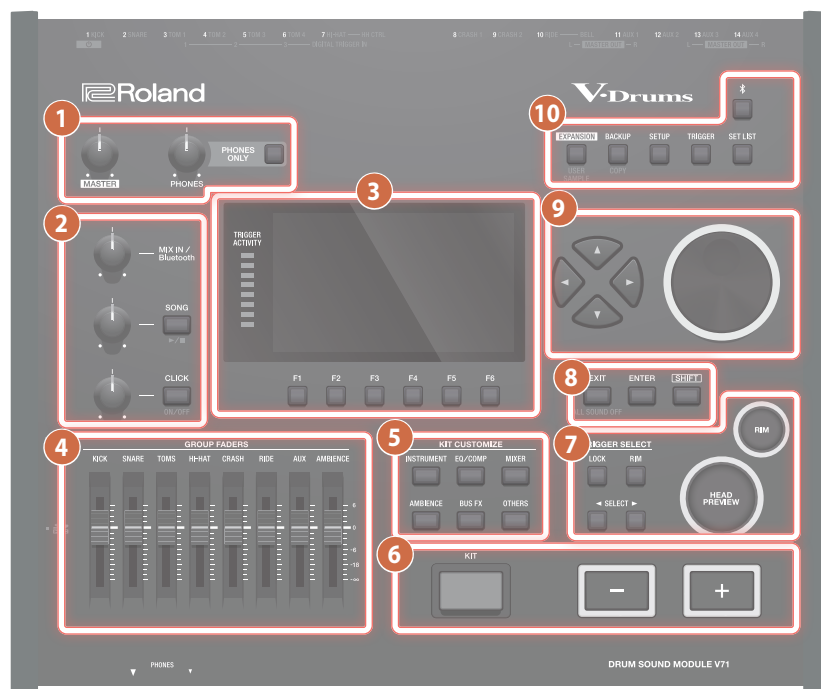

1

[MASTER] knob

Adjusts the volume of signal output from the MASTER OUT connectors.

[PHONES] knob

Adjusts the volume of headphones connected to the PHONES jack.

[PHONES ONLY] button

Long-press the [PHONES ONLY] button (the button blinks) to hear only the audio output from the PHONES jack. Audio signals are not output from any other jacks.

This is useful when you want to check the sound beforehand, such as during a live performance.

2

[MIX IN/Bluetooth] knob

Adjusts the volume of audio input from the MIX IN (STEREO) jack and the volume of the **Bluetooth** audio.

[SONG] knob

Adjusts the volume of a song (audio file). Note that this has no effect on the built-in drum performance sounds or the performance sounds of recorded drums (p. 16).

[SONG] button

Shows the SONG screen. Press this when you want to play back a song or recorded data, or to make song-related settings (p. 16).

Press the [SONG] button while holding down the [SHIFT] button to play back or stop a song or recorded data.

[CLICK] knob

Adjusts the click volume (p. 15).

[CLICK] button

Lets you play the click sound and make tempo or click-related settings.

You can also use this for training your sense of rhythm (p. 15).

Further, you can turn the click on/off by holding down the [SHIFT] button and pressing the [CLICK] button.

3

Function button ([F1]–[F6])

The function of these buttons changes depending on what is shown in the display. This sets the functions shown in the lower part of the display.

TRIGGER ACTIVITY indicators

These indicators light when a trigger signal (the signal output from a pad when it is struck) is received. Use them to check whether the pads are properly connected.

Display

Shows various information according to the operation.

4 **Faders**

Use these to adjust the volume of the kick, snare, hi-hat, other percussion instruments, as well as the ambience and so on.

5 **KIT CUSTOMIZE**

[INSTRUMENT] button

Sets the instrument (sound) (p. 18).

[EQ/COMP] button

Configures the equalizer, compressor and other effects for each pad or drum kit (p. 19).

[MIXER] button

Configures the volume, pan and other effects for each pad or drum kit (p. 19).

[AMBIENCE] button

Sets the sound heard from the overhead mic that picks up sounds from the entire drum kit, how the drums reverberate depending on where they are played and how the drums sound (p. 20).

[BUS FX] button

Sets the effects assigned to the bus (the signal path that the audio is sent through) and the routing (the order in which the effects are connected) (p. 20).

[OTHERS] button

Configures various settings for the drum kit (p. 21).

6

[KIT] button

Shows the KIT screen.

[-] [+] buttons

Use these buttons to switch between drum kits and change values.

Press the [-] [+] buttons while holding down the [SHIFT] button to make the values change in larger increments.

7 **TRIGGER SELECT****[LOCK] button**

When you press the [LOCK] button to make it light up, the pad to set does not switch to a different pad even if you strike it. This is useful if you're playing a phrase while you set the pads.

[RIM] button

When using a pad that supports rim playing, this selects whether to set the head or the rim. For pads that support three-way triggering, this switches between the head, rim and bell.

SELECT [◀] [▶] buttons

These select the pad to set (trigger input number).

[HEAD PREVIEW] button, [RIM] (PREVIEW) button

Use these buttons to preview the instruments. The volume changes in response to how hard you press the buttons. You can preview the sounds of the head and rim sides separately.

If you use the SELECT [◀] [▶] buttons to select a trigger input number, you can still hear sound even when the V71 is not connected to a pad.

* If the kick drum is assigned to a pad (trigger input number), no sound is heard when you play the [RIM] (PREVIEW) button.

NOTE

You may hear the preview sound when the V71 is exposed to a strong impact. If this happens, you can turn the preview function off by following the steps below.

Press either the [HEAD PREVIEW] or [RIM] (PREVIEW) button while holding down the [KIT] button → set the Preview Mode parameter to "PREVIEW OFF"

8

[EXIT] button

Press this once to return to the next-higher-level screen. When you press this several times in a row, the display eventually returns to the KIT screen.

Also, when you press the [EXIT] button while holding down the [SHIFT] button, this stops (mutes) all of the sounds that are playing (ALL SOUND OFF (*1)). This is useful when you want to stop several loop phrases all at once.

*1: The effect reverberation, the song and the click do not stop.

[ENTER] button

Press this button to confirm a value or operation.

[SHIFT] button

This is used in conjunction with other buttons. The function of other buttons changes while you are holding down this button.

9

[▲] [▼] [◀] [▶] buttons (cursor buttons)

These buttons move the cursor.

Dial

This functions in the same way as the [-] [+] buttons. Use this dial when you want to make larger changes to the drum kit or settings.

You can also turn the dial while holding down the [SHIFT] button to make the values change in larger increments.

10

[EXPANSION] button

Use this button to configure the instrument expansions (drum kit and instrument packages) that you've installed on the V71 from Roland Cloud (p. 14).

Press the [EXPANSION] button while holding down the [SHIFT] button to use the User Sample function (p. 22).

[BACKUP] button

Backs up and loads the overall settings for the V71 and the drum kit settings to/from an SD card (p. 24).

Also, you can copy settings such as drum kit and instruments by pressing the [BACKUP] button while holding down the [SHIFT] button.

[SETUP] button

Use this button for settings related to the V71 overall, such as output destination (output assign), MIDI and so on.

[TRIGGER] button

Sets the trigger parameters (p. 23).

[SET LIST] button

Use this button to create set lists, and to switch between drum kits in the order specified in the set list. The [SET LIST] button lights when the Set List function is on.

[*] (Bluetooth) button

You can wirelessly connect this unit to a smartphone or other mobile device (hereafter "smartphone"), and play the drums while a song plays back from your smartphone (p. 15).

Side panel and front panel

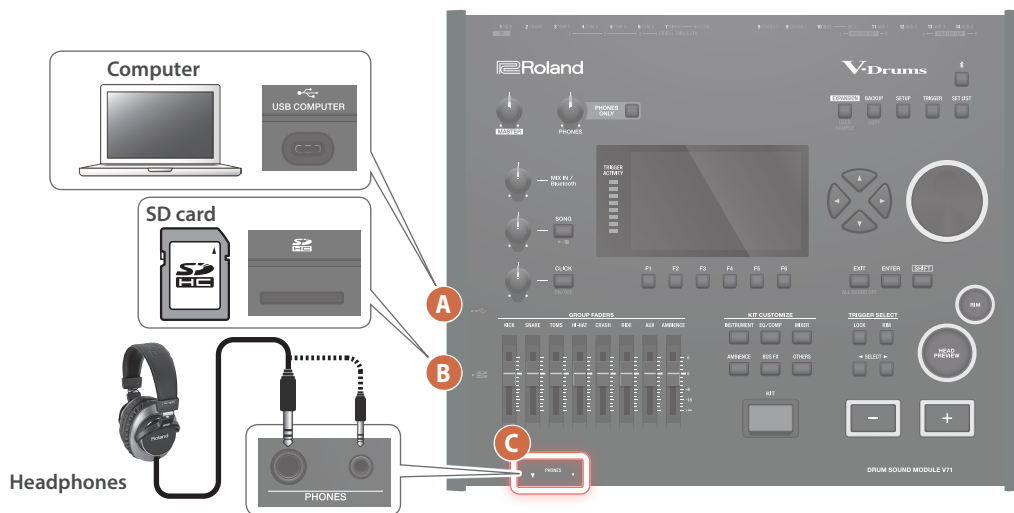

A USB COMPUTER port

Connect your computer to the V71's USB port via USB cable. You can use DAW software to record what you play on the V71 as audio or MIDI data, or you can use the V71 to hear sound that's played back from your computer.

You can use the "V71 Editor" app to edit drum kits on your computer (p. 26).

- * Do not use a USB cable that is designed only for charging a device. Charge-only cables cannot transmit data.

B SD card slot

Insert a commercially available SD card (SDHC cards with up to 32 GB capacity are supported).

You can save the songs and data from the V71 to an SD card. You can also use an SD card to import user samples, export the songs that you recorded and so on.

Before using an SD card for the first time, you must format it on this unit (p. 24).

- * Never turn off the power or remove the SD cards while the screen indicates "Processing...".
- * Some memory card types or memory cards from some manufacturers may not record or play back properly on the unit.

C PHONES jack

Connect your headphones here.

Even if headphones are connected, sound is still output from the output jacks.

Bottom panel

Mounting the unit onto a stand

Attach the V71 to a drum stand using the sound module mounting plate.

The sound module mounting plate is included with the separately sold drum stands (e.g., the MDS or PDS series).

Use the screws at the bottom of the V71 to mount the sound module as shown in the illustration.

- * Do not use screws other than those on the bottom of the V71. Using improper screws may cause the unit to malfunction.
- * When turning the unit over, be careful so as to protect the buttons and knobs from damage. Also, handle the unit carefully; do not drop it.

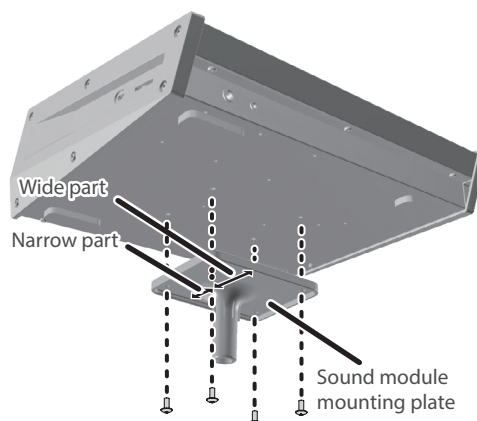

Rear panel (connecting your equipment)

* To prevent malfunction and equipment failure, always turn down the volume, and turn off all the units before making any connections.

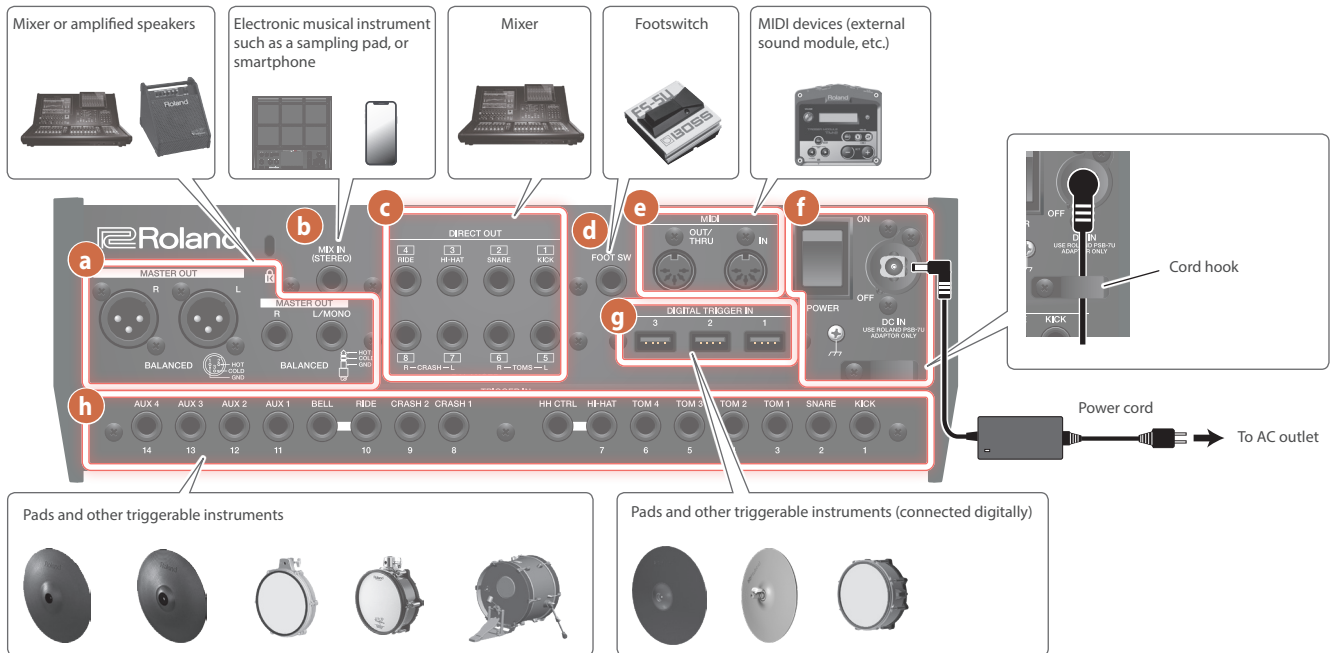

a MASTER OUT connectors (balanced)

Connect these to your amplified speakers, mixer, recording equipment and similar devices.

To output in mono, connect only the L/MONO jack of the MASTER OUT (1/4-inch TRS phone type).

* Pin assignment of MASTER OUT connectors



b MIX IN (STEREO) jack

Connect an electronic musical instrument such as a sampling pad, or a smartphone here.

c DIRECT OUT (BALANCED) jacks

Connect these to your mixer or other audio device.

Use the [SETUP] button to set the DIRECT OUT 1–8 jacks to which the instruments or other sounds are output.

* Pin arrangement of DIRECT OUT (BALANCED) jacks

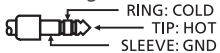

d FOOT SW jack

You can connect a footswitch (BOSS FS-5U, FS-6; sold separately) and use it to control various parameters.

e MIDI connectors

Connect these to external MIDI devices such as an external sound module.

f

[POWER] switch

Turns the power on/off.

DC IN jack

Connect the included AC adaptor to this jack.

* Use the cord hook to secure the cord of the AC adaptor as shown in the illustration.

Ground terminal

Connect this to an external earth or ground.

g DIGITAL TRIGGER IN ports

Connect pads that support digital connections (such as the PD-14DSX, PD-140DS, CY-18DR or VH-14D).

h TRIGGER IN jacks

Connect these jacks to the cymbals, hi-hat, kick drums and so on.

* Use a stereo type (TRS) cable when connecting a dual-trigger type pad.

Turning the power on/off

- * Once everything is properly connected (p. 5), be sure to follow the procedure below to turn on their power. If you turn on equipment in the wrong order, you risk causing malfunction or equipment failure.
- * Before turning the unit on/off, always be sure to turn the volume down. Even with the volume turned down, you might hear some sound when switching the unit on/off. However, this is normal and does not indicate a malfunction.

Turning the power on

1. Turn the volume of the V71 and the connected devices all the way down.
2. Turn the [POWER] switch of the V71 to "ON".

When you turn the unit on, the following screen appears.

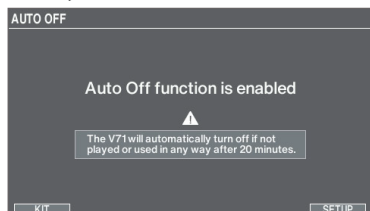

- * If the Auto Off function is set to "OFF", this screen doesn't appear.
- * To change the Auto Off function settings, press the [F6] (SETUP) button. For details, refer to "Making the power automatically turn off after a time (AUTO OFF)" (p. 6).

3. Press the [KIT] button to return to the KIT screen.
4. Turn on the connected devices and adjust the volume.

Turning the power off

NOTE

Settings that you edit on the V71 are saved when you turn off the unit. Be sure to turn off the unit by turning the [POWER] switch to "OFF".

1. Turn the volume of the V71 and the connected devices all the way down.
2. Turn off the connected devices.
3. Turn the [POWER] switch of the V71 to "OFF".

The message "Please wait. Now saving..." is shown, and the power turns off once the settings are saved.

Making the power automatically turn off after a time (AUTO OFF)

The power to this unit turns off automatically to save energy after a certain amount of time (20 minutes by default) has passed since it was last used or since its buttons or controls were operated.

- * If the power automatically turns off, any unsaved data is lost. Before the power turns off, save the data that you want to keep.
- * If you don't want the unit to turn off automatically, turn this setting off. Note that when the setting is turned off, the unit may consume more power.
- * You can simply turn the power back on after it has turned off automatically.

1. Press the [SETUP] button.
2. Use the cursor buttons to select "OPTION" and press the [ENTER] button.
3. Press the [F5] (AUTO OFF) button.

The AUTO OFF screen appears.

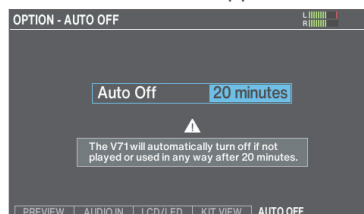

4. Use the [-] [+] buttons or the dial to set the Auto Off function.

| Value | Explanation |
|------------------------------|---|
| OFF | The power does not turn off automatically. |
| 20 minutes (factory setting) | Turns the power off automatically when no pad has been struck and no operation performed within the specified time (20 minutes or 4 hours). |
| 4 hours | |

- * A confirmation message appears if you select a value besides "20 minutes". Select "OK" and press the [ENTER] button.

5. Press the [KIT] button to return to the KIT screen.

MEMO

If you set the Auto Off function to "20 minutes" or "4 hours", the remaining time before the unit turns off is shown either 10 minutes (for the "20 minutes" setting) or 30 minutes (for the "4 hours" setting) before the unit turns off.

Configuring pads that support digital connection

The first time that a pad that supports digital connection is connected to a DIGITAL TRIGGER IN port, the following screen appears.

Following the onscreen instructions, specify the trigger input to which the connected pad should be assigned.

- * If you assign the same trigger input used by a pad connected to a TRIGGER IN jack, the pad that's connected to that TRIGGER IN jack does not output sound.

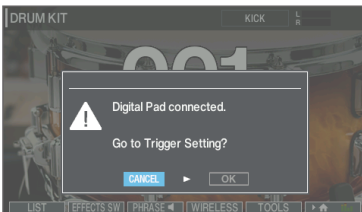

➔ For details on the pad settings, refer to the "Reference Manual" (Roland website).

1. Select "OK" and then press the [ENTER] button.

The TRIGGER - DIGITAL PAD screen appears.



2. Use the cursor buttons to select "Assign" for the pad that you want to configure, and use the [-] [+] buttons or the dial to set the assignment.

When you select a pad, its [FUNC] button blinks.

Examples of settings:

| Pad | Assign |
|--------------------|--------|
| PD-14DSX, PD-140DS | SNARE |
| CY-18DR | RIDE |
| VH-14D | HI-HAT |

- * You can't specify multiple instances of the same assignment.

3. Press the [KIT] button to return to the KIT screen.

The following screen is shown when you connect a pad that's an older version. Update the pad

If the following screen appears, the pad may not function properly with the V71 until you update its firmware. Follow the steps below to update the pad.

- * You can also connect the pad to your computer to update it. For details, refer to the support page for each pad.

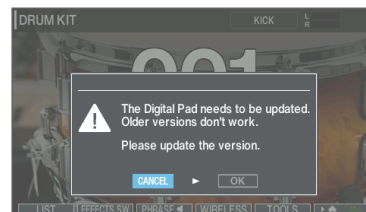

1. Select "OK" and then press the [ENTER] button.

The SYSTEM INFO - DIGITAL PAD screen appears.

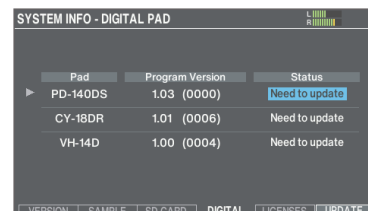

2. Position the cursor on "Need to update", and press the [F6] (UPDATE) button.

A confirmation message appears.

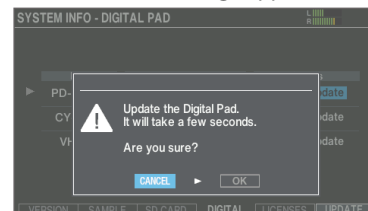

If you decide to cancel, select "CANCEL" and press the [ENTER] button.

3. Once the confirmation message appears, use the cursor buttons to select [OK] and press the [ENTER] button.

The pad update begins.

The update is complete once "Complete!" appears and the status reads "OK".

- * The update may take several minutes.
- * Never disconnect the digital pads or turn off the power while you see the message "Processing..." on the screen.
- * If you unplug a digital pad during the update, or if the update fails due to the power of the V71 being turned off, the V71 may no longer be able to recognize the digital pad. For how to deal with this, refer to the "Reference Manual" (Roland website).

4. Press the [KIT] button to return to the KIT screen.

Configuring the hi-hat

If you're using a V-hi-hat (such as a VH-14D or VH-13), adjust the offset on the V71.

This is necessary to correctly detect open/close operations and pedal movement.

Example: settings for the VH-14D

MEMO

You can also adjust the offset by holding down the [KIT] button and pressing the [TRIGGER] button.

1. Press the [TRIGGER] button.
2. Press the [F4] (HI-HAT) button.

The TRIGGER - HI-HAT screen appears.

Make sure that Trig Type is set to "VH-14D".

- * "VH-14D" is not shown for the Trig Type if the VH-14D is not connected or if it is not assigned to the hi-hat. If this happens, connect the VH-14D and assign it to the hi-hat (p. 5).

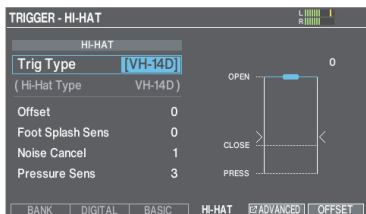

3. Press the [F6] (OFFSET) button.

The HI-HAT OFFSET ADJUSTMENT screen appears.

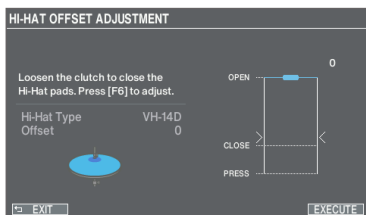

4. Loosen the clutch screw of the VH-14D so that the hi-hat is closed.

- * Do not touch the hi-hats or the pedal.

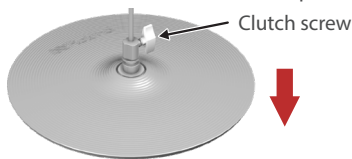

5. Press the [F6] (EXECUTE) button.

"Processing..." is shown once calibration begins.

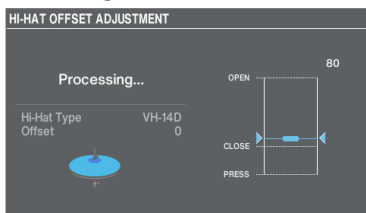

"Complete!" is shown once calibration is finished, and the display returns to the TRIGGER screen.

6. Press the [KIT] button to return to the KIT screen.

Make detailed adjustments to the parameters as necessary.

→ "Reference Manual" (Roland website)

Basic operations

Adjusting the overall volume ([MASTER] knob or [PHONES] knob)

Use the [MASTER] knob to adjust the volume output from the MASTER OUT jack, and the [PHONES] knob to adjust the headphone volume.

Switching between tabs and setting the functions ([F1]–[F6] buttons)

You can use the [F1]–[F6] buttons to switch between the tabs shown in the tabs shown in the lower part of the display, or to set the functions shown in the lower part of the display.

Moving the cursor (cursor buttons)

The cursor highlights the area of the screen where you can change the settings. If there are multiple items on the screen, press the cursor buttons to move the cursor to the item you want to set.

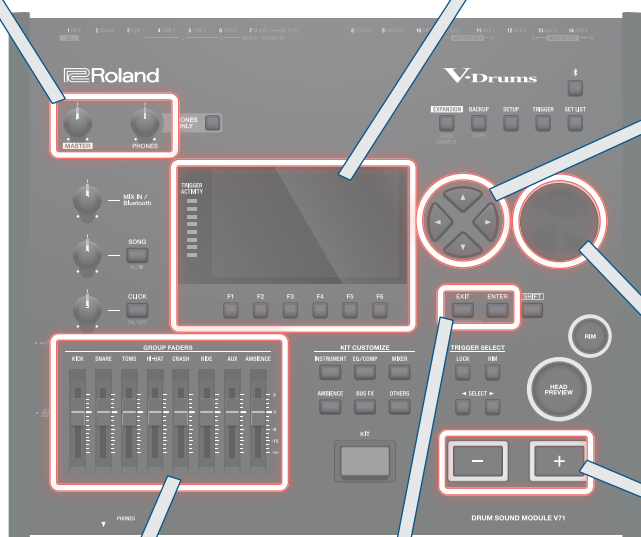
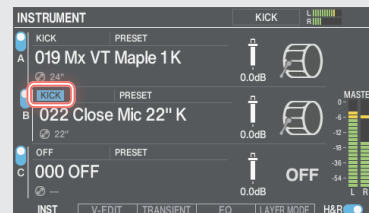
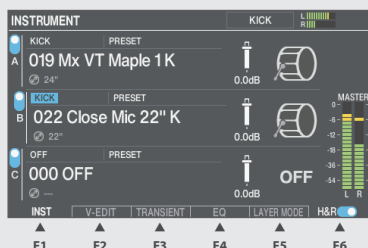

Adjusting the volume balance of the pads (faders)

You can adjust the overall volume balance for the V71 with the faders.

With the mixer (p. 19), you can adjust the volume balance between the pads in a drum kit. The mixer settings can be saved for each drum kit.

You can adjust the following trigger inputs and volumes.

| Fader | Explanation |
|----------|-------------|
| KICK | KICK |
| SNARE | SNARE |
| TOMS | TOM 1–4 |
| HI-HAT | HI-HAT |
| CRASH | CRASH1, 2 |
| RIDE | RIDE |
| AUX | AUX1–4 |
| AMBIENCE | AMBIENCE |

Returning to the previous screen ([EXIT] button)

Press the [EXIT] button to return to the previous screen.

Confirming an operation ([ENTER] button)

Use this to confirm a value, execute an operation or to view a list.

Changing values ([–] [+] buttons or dial)

Use the dial or the [–] [+] buttons to edit the value highlighted by the cursor. Hold down the [SHIFT] button while using these controls to change the value in larger increments.

MEMO

If you hold down the [+] button and press the [–] button, the value increases quickly. If you hold down the [–] button and press the [+] button, the value decreases quickly.

Performance techniques

As with an acoustic drum kit, the V71 supports a variety of playing techniques.

NOTE

- Use wood or plastic sticks. Using carbon or metal sticks might make the sensors malfunction.
- Use nylon brushes. Using metal brushes might make the sensors malfunction or scratch the pad.

Pads

Head shot

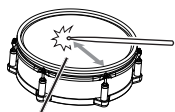

Tone changes depending on strike point

Strike the head of the pad.

On certain snare drum sounds, the tone changes naturally as you move the strike point from the center of the head toward the rim.

Rim shot

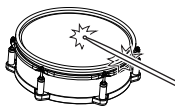

Strike the head and the rim together. This gives you a different sound (a rim tone) from head shots.

Cross stick



Strike the rim while placing your hand on the snare head.

You can make the sound differ depending on your playing technique. For example, you can hear a rim sound when playing a rim shot, or a cross-stick sound when playing with a cross-stick technique.

Connect a pad that supports rim shot techniques to the TRIGGER IN (2 SNARE) jack, or connect a digitally-connected pad (such as the PD-14DSX or PD-140DS) that supports cross-stick techniques and assign the pad to the snare drum.

For pads other than the PD-14DSX or PD-140DS, strike the rim only—do not touch the head.

Playing with brushes

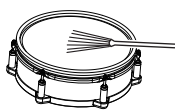

You can use brushes to scrape the head (brush sweep).

Connect a pad with a mesh head to the TRIGGER IN (2 SNARE) jack, or connect a digitally-connected pad (such as the PD-14DSX or PD-140DS) that supports brush playing techniques and assign it to the snare.

* For drum kits on which the snare brush sound is assigned, you can use the brush sweep technique when Brush Switch is "ON".

For details, refer to the "Reference Manual" (Roland website).

Changing the tone according to the nuances of the rim shot

With certain snare and tom sounds, the nuance of the sound changes when you slightly change how you play the rim shots.

Normal rim shot (Open rim shot)

Strike the center of the head and the rim at the same time.

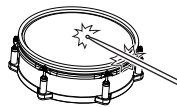

Shallow rim shot (Shallow rim shot)

Strike the head near the rim and the rim itself at the same time.

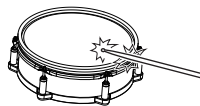

Using the strainer (PD-14DSX)

Operate the strainer (throw-off) lever to "attach" the snare wires to the snare (bottom side; ON) or to "detach" them (OFF) for a specific snare sound.

The volume of the operating sound changes according to how fast you operate the lever. Aside from the snare wire operation, you can also assign functions to the strainer for controlling effects and so on.

On

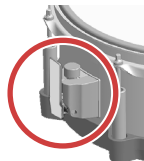

Off

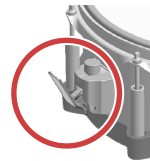

You can assign a variety of functions to the strainer, such as turning the strainer knob to adjust the tension of the snare wires, or pressing the knob to play or stop a song.

Strainer knob

Press (switch)



Turn (knob)

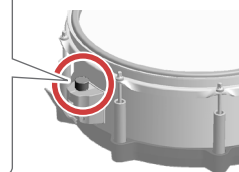

➔ For details, refer to the "Reference Manual" (Roland website).

How strike positions are detected on digital drums

For digitally-connected pads, the position at which you strike the pad is detected (strike position detection).

Here is an example. On the snare drum, the sound changes according to the strike position, such as when striking the center of the pad face versus the edge, or the right side versus the left side.

Center versus edge of pad face



Position struck on pad face

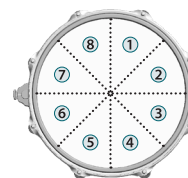

Hi-hat

Open/closed

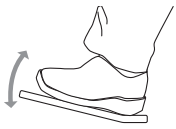

The hi-hat tone changes continuously from open to closed in response to how far the hi-hat stand pedal is pressed.

You can also play a foot-close sound by pressing the pedal, or a foot-splash sound by pressing the pedal and then immediately opening it.

Pressure (VH-14D, VH-13)



When you strike the hi-hat while pressing on the pedal with the hi-hat closed, the closed hi-hat tone changes in response to how hard you press down on the pedal.

The VH-11, VH-10, FD-9 and FD-8 do not respond to pressure.

Bow shot

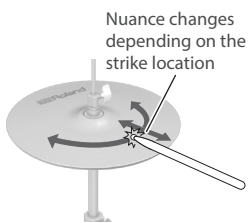

This is the technique used when striking the surface of the top cymbal. It corresponds to the sound of the "head side" of the connected trigger input.

If you are using a pad that distinguishes between where you strike it (such as the VH-14D), the nuances of certain hi-hat sounds change depending on where you strike the bow.

Edge shot

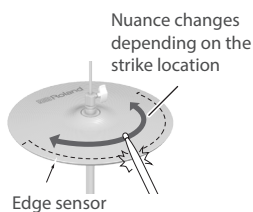

This technique involves striking the edge of the top cymbal with the shoulder of the stick. When the edge sensor position is struck as shown in the illustration, the "rim side" sound of the connected trigger input is triggered.

Striking directly on the edge (i.e., exactly from the side) will not produce the correct sound. Strike as shown in the illustration.

If you are using a pad that distinguishes between where you strike it (such as the VH-14D), the nuances of the sound change with some hi-hat sounds, depending on where you strike the edge.

Choke

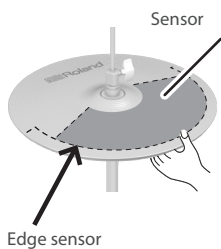

If you use your hand to choke (grasp) the edge sensor after striking the hi-hat cymbal, the sound stops.

On the VH-14D, the sound stops if you place your hand on (mute) the sensor detection area.

When you strike the cymbal in the choked or muted state, a shorter sound plays.

Cymbal

Bow shot

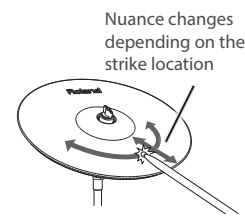

This is the most common method of playing the cymbal. It corresponds to the sound of the "head side" of the connected trigger input.

For certain ride sounds, the tonal nuance changes depending on where you strike the bow.

Edge shot

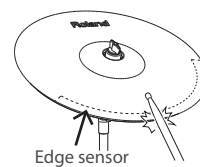

This playing method involves striking the edge of the cymbal with the shoulder of the stick. When the edge sensor position is struck as shown in the illustration, the "rim side" sound of the connected trigger input is triggered.

Striking directly on the edge (i.e., exactly from the side) will not produce the correct sound. Strike as shown in the illustration.

If you are using a pad that distinguishes between where you strike it (such as the CY-18DR), the nuances of the sound change depending on where you strike the edge.

Bell shot

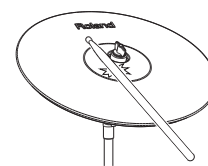

This playing method involves striking the bell of the cymbal. When the bell area shown in the illustration is struck, the bell sound is heard.

Connect a pad that can be connected to the TRIGGER IN (10 RIDE - BELL) jack, or connect a digitally-connected pad (such as the CY-18DR) that lets you use the bell shot playing technique, and assign it to the ride.

Choke

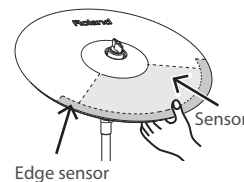

If you use your hand to choke (grasp) the edge sensor after striking the cymbal, the sound stops (mute).

On the CY-18DR, placing your hand on the sensor also stops the sound.

When you strike the cymbal in the choked or muted state, a shorter sound plays.

Playing

Drum kits and instruments

On the V71, the sounds that play when you strike each pad are called “instruments”. A set of sounds (instruments) allocated to the respective pads is called a “drum kit”.

The structure of a drum kit is shown below.

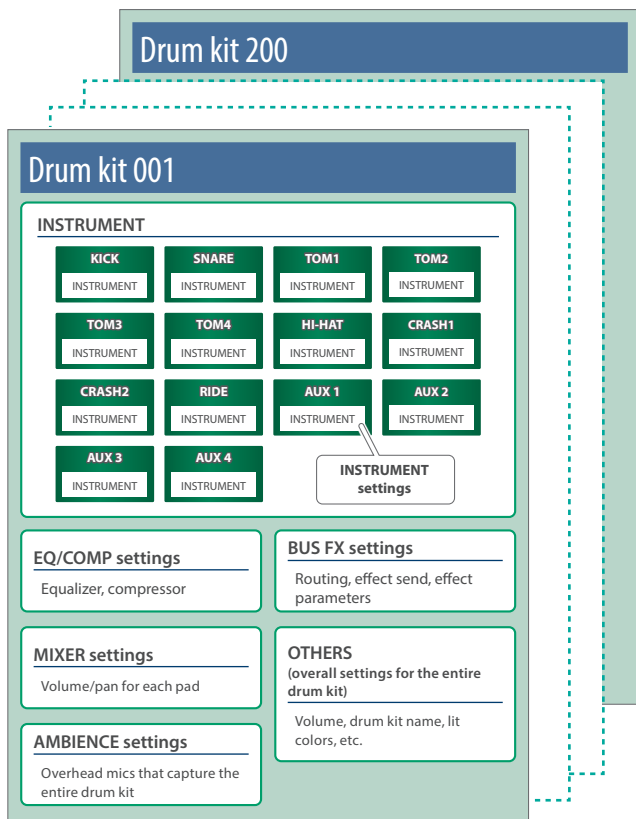

Racks and slots

On Roland Cloud, you can find Instrument Expansions such as renowned drum kit sounds like the DW, our V-Drums flagship model sounds from the past, sounds that were created in collaboration with other artists and more.

Use the Roland Cloud Connect smartphone app or the Roland Cloud Manager app for your computer to install these Instrument Expansions from Roland into the “racks” of the V71, and load them into the slots.

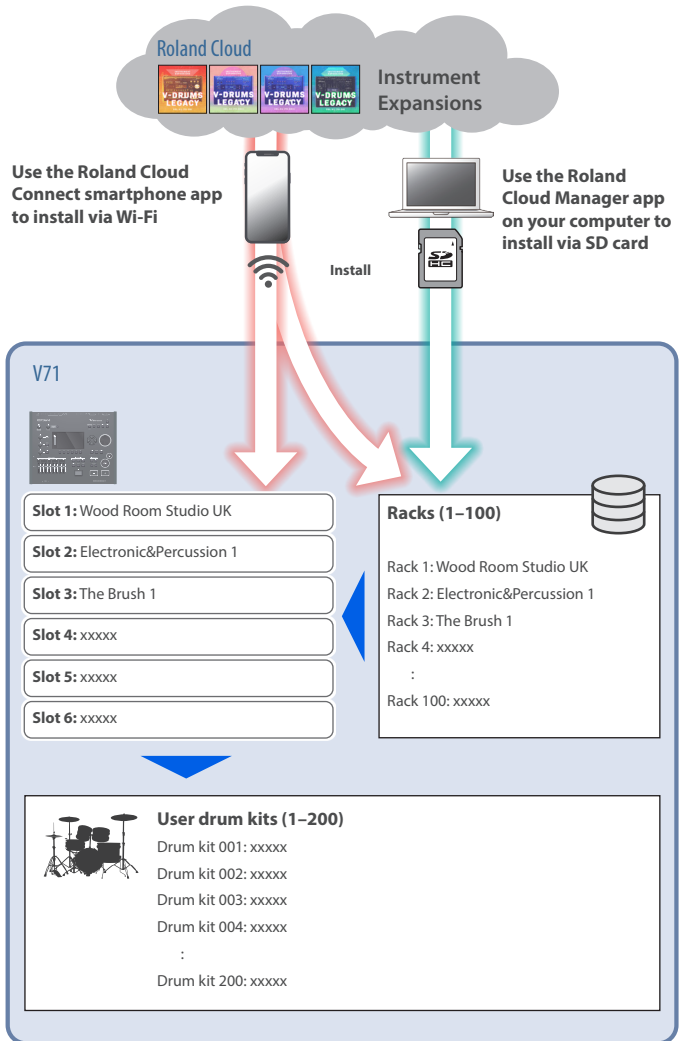

Instrument Expansions

In addition to the built-in preset instruments and drum kits, Roland also offers Instrument Expansions.

An Instrument Expansion is a package containing multiple drum kits, along with advanced modeled sounds called “instruments” that include sample waveforms.

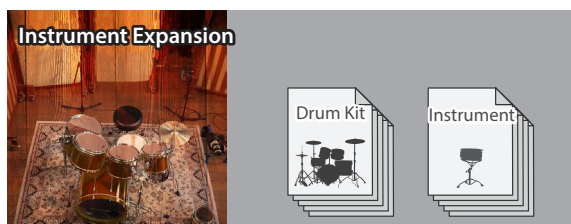

MEMO

- See the “Roland Cloud Connect Setup Guide” (separate document) for how to install Instrument Expansions via the Roland Cloud Connect smartphone app.
- See the “Roland Cloud User’s Guide” (Roland website) for how to install Instrument Expansions via the Roland Cloud Manager app on your computer.

* Please be aware that in some countries or regions, it might not be possible to use Roland Cloud at this time.

Racks (1–100)

A “rack” is a storage area that lets you install up to 100 Instrument Expansions.

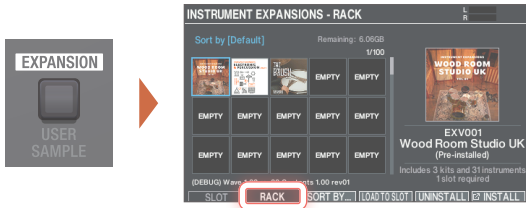

Slots (1–6)

You can play the Instrument Expansions that you’ve installed in a rack by loading them into a slot (p. 14). You can load a maximum of six Instrument Expansions into slots 1–6.

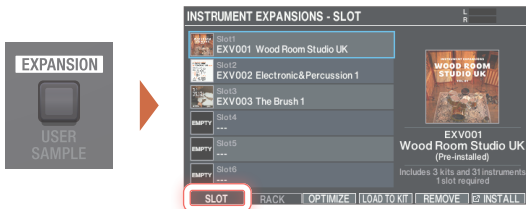

MEMO

Racks and slots 1–3 contain factory preloaded Instrument Expansions.

User drum kits (001–200)

By loading the drum kits in the Instrument Expansions that are already in slots 1–6 into user drum kits 001–200, you can quickly call up and play the drum kits with the [KIT] button or by selecting from the drum kit list.

- * You can overwrite the factory preset drum kits to save your own drum kit data. If you want to recall the factory preset drum kits, you can reload the drum kits all at once, or kit by kit. For details, refer to “Restoring the factory settings” (p. 27), “Restoring the drum kit to factory settings” (p. 28).

Selecting a drum kit

1. Press the [KIT] button.

The KIT screen appears.



2. Use the [-] [+] buttons or the dial to select a drum kit.

About the KIT screen

This is the main screen for the V71, which appears when you press the [KIT] button.

- Brush icon**: Shown when the Brush Switch is “ON”
- Tempo**: Shown when the kit tempo is “ON”
- Favorite icon**: Shown only if a drum kit registered as a favorite (p. 17) is selected
- User sample icon**: Shown when a drum kit that uses user samples (p. 22) is selected
- Expansion icon**: Shown when a drum kit is selected that uses an instrument from an Instrument Expansion (p. 14)
- Currently selected pad**: MASTER OUT output volume
- Bluetooth icon**: Shown when connected via Bluetooth
- Wi-Fi icon**: Shown when connected via Wi-Fi

Other visible elements: Drum kit number (001), Drum kit name (Studio A), and various control buttons like LIST, EFFECTS SW, PHRASE, WIRELESS, TOOLS.

Selecting a drum kit from the list

On the KIT screen, press the [F1] (LIST) button to display the KIT LIST window, and select a drum kit from the list.

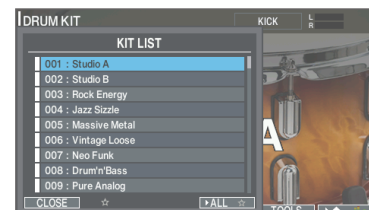

Loading drum kits from the Instrument Expansions

Slots 1–3 contain factory preloaded Instrument Expansions. You can use the steps below to load and play the drum kits.

1. Press the [EXPANSION] button.
2. Press the [F1] (SLOT) button.

The INSTRUMENT EXPANSIONS - SLOT screen appears.

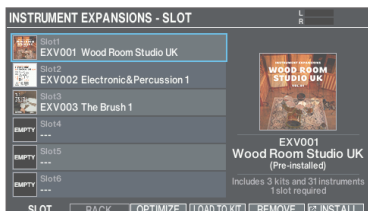

3. Move the cursor to the Instrument Expansion that you want to load, and press the [F4] (LOAD TO KIT) button.

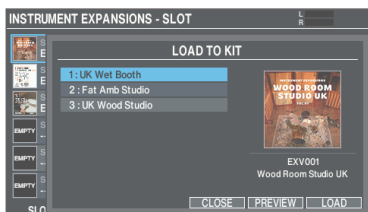

Press the [F5] (PREVIEW) button to check the sound of a drum kit before you load it.

4. Move the cursor to the drum kit of the Instrument Expansion that you want to load, and press the [F6] (LOAD) button.

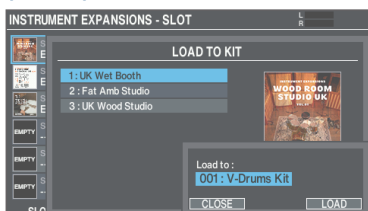

5. Use the [-] [+] buttons or the dial to select the destination drum kit to which you want to load.

6. Press the [F6] (LOAD) button.

A confirmation message appears.

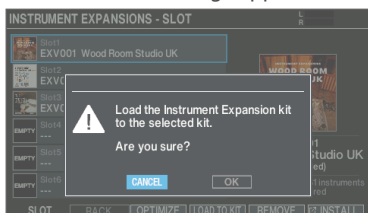

7. Select “OK” and then press the [ENTER] button.

This loads the drum kit.

MEMO

See the “Roland Cloud Connect Setup Guide” for how to install Instrument Expansions from Roland Cloud.

Using the click sound

Turning the click on/off

1. Press the [CLICK] button.

The CLICK screen appears.



2. Press the [F6] button.

The click sounds.

To adjust the click track volume, turn the [CLICK] knob.

3. Press the [F6] button once again.

The click stops.

MEMO

- You can also turn the click on/off by holding down the [SHIFT] button and pressing the [CLICK] button.
- You can also output the click only to headphones.
→ "Reference Manual" (Roland website)

Adjusting the tempo

1. From the CLICK screen, select "Tempo", and use the [-] [+] buttons or the dial to change the tempo.

MEMO

Press the [-] [+] buttons or use the dial while holding down the [SHIFT] button to change the values in decimal points.

Changing the beat (time signature) settings

1. From the CLICK screen, select "Beat", and use the [-] [+] buttons or the dial to change the tempo.

2. Press the [KIT] button to return to the KIT screen.

For other parameters you can set, refer to the "Reference Manual" (Roland website).

Playing along with a song

You can enjoy playing the drums along with songs played back on your smartphone, or with songs that can be played back on this unit.

Playing along with a song from your smartphone

You can play along with a song on your smartphone that plays through this unit.

Connecting wirelessly via Bluetooth

In order to connect your smartphone wirelessly to this unit via Bluetooth, you'll need to "pair" by registering it in your smartphone so that the two devices can authenticate with each other.

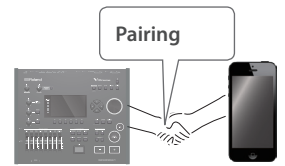

As an example, we explain how to make settings for an iPhone.

- * Once a smartphone has been paired with this unit, there is no need to pair it again. Refer to the steps in "Connecting an already-paired smartphone" (p. 16).

Registering the smartphone (pairing)

- 1. Place the smartphone that you want to connect near the V71.**
- 2. Press the [⌘] (Bluetooth) button.**
- 3. Press the [F6] (Bluetooth) button to turn Bluetooth Switch "ON".**
- 4. Press the [F1] (PAIRING) button.**

The display indicates "Now Pairing...", and the V71 waits for a response from the mobile device.

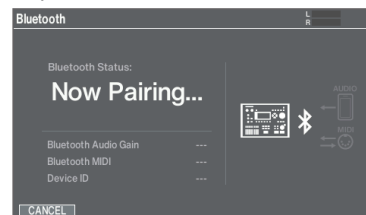

5. In your smartphone's settings, turn Bluetooth on.

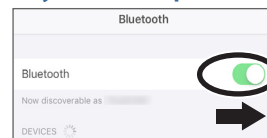

6. Tap "V71 AUDIO" that appears in the Bluetooth "DEVICES" list on your smartphone.

This pairs the unit with the smartphone. When pairing is completed, a display like the following appears.

| | |
|------------|--|
| smartphone | "V71 AUDIO" is added to the "My devices" area, and shown as "Connected". |
| V71 | The screen indicates "Connected (AUDIO)". |

7. Press the [KIT] button to return to the KIT screen.

Connecting an already-paired smartphone

1. In your smartphone's settings, turn Bluetooth on.

The smartphone and this unit are connected Bluetooth.

- * If the above step does not establish a connection, tap "V71 AUDIO" as shown in the "DEVICES" field on the smartphone.

Playing back songs from your smartphone

When you play back a song on your smartphone, you hear the sound from the headphones or amplified speakers that are connected to this unit.

To adjust the song's volume, use the [MIX IN/Bluetooth] knob or the Bluetooth Audio Gain parameter on this unit, or adjust the volume on your smartphone.

MEMO

- You can control the song that's playing on your smartphone from this unit. For details, refer to "Reference Manual" (Roland website).
- The song played back on your smartphone can be recorded along with the sound of your performance on the V71.
- Connect your smartphone to the MIX IN (STEREO) jack to hear the songs playing on your smartphone while you play the sounds on this unit.
- * Some smartphones and music playback apps may not let you control the song from the V71.

Playing along with the songs on the V71

This unit features songs in a variety of genres.

Some of the built-in songs are provided as audio data, and others are MIDI data recordings of drum performances. You can also play audio files (WAV/MP3) stored on an SD card as songs.

1. Press the [SONG] button.

The SONG screen appears.

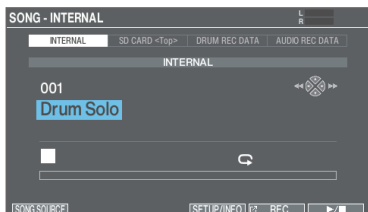

2. Press the [F1] (SONG SOURCE) button to show the SONG SOURCE list, and press the [F1] (SELECT) button to select the type of song you want to play back.

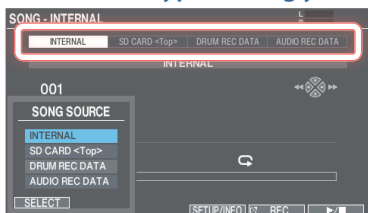

| Song type | Explanation |
|----------------|--|
| INTERNAL | Built-in songs |
| SD CARD<Top> | Songs stored on SD card |
| DRUM REC DATA | Songs recorded on this unit as drum performance data |
| AUDIO REC DATA | Songs recorded on this unit as audio data |

3. Move the cursor to the song, and use the [-] [+] buttons or the dial to select the song.

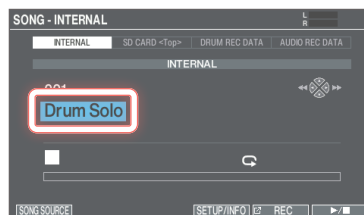

4. Press the [F6] (▶/■) button.

The selected song plays.

| Controller | Function |
|----------------------|---|
| [F6] (▶/■) button | Plays/stops the song *1 |
| [SHIFT] + [◀] button | Returns to the beginning of the song *1 |
| [SHIFT] + [▶] button | Moves to the end of the song *1 |
| [◀] button | Rewinds the song *1 |
| [▶] button | Fast-forwards the song *1 |
| Dial | Fast-forwards/rewinds the song *1, *2 |
| [SONG] knob | Adjusts the song (audio file) volume *3 |

*1: Depending on the type of song, this might be disabled.

*2: Only enabled when the cursor is on the seek bar (the bar that shows the playback position).

*3: Note that this has no effect on the built-in drum performance sounds or the performance sounds of recorded drums.

MEMO

- You can repeatedly play back an entire song or just one part.
- You can make the click sound in time with the song by outputting an audio file on the SD card as a click track.
→ "Reference Manual" (Roland website)

When saving audio files from your computer to an SD card

Audio files can be played back from the top directory (root) of the SD card.

- * You can save up to 200 song files in a single folder.
- * Keep the song length within one hour per file.

MEMO

For details, refer to "Reference Manual" (Roland website).

Audio files that can be played on the V71

| | WAV | MP3 |
|--------------------|-------------|------------------|
| Format (extension) | WAV (.wav) | MP3 (.mp3) |
| Sampling frequency | 44.1 kHz | 44.1 kHz |
| Bit rate | 16, 32 bits | 64 kbps–320 kbps |

- * File names or folder names that contain more than 16 characters are not shown correctly. Also, file/folder names with double-byte characters are not supported.

Registering/recalling your favorite drum kits

You can register your favorite drum kits and recall them instantly.

Registering a drum kit as a favorite

1. On the KIT screen (p. 13), press the [F1] (LIST) button.

The KIT LIST window appears.

2. Use the cursor [▲] [▼] buttons or the dial to move the cursor to the drum kit you want to register.
3. Press the [F2] (★) button.

A star (★) appears next to the drum kit name. The drum kit is now registered as a favorite.

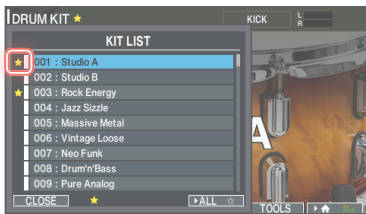

MEMO

To deregister a favorited drum kit, press the [F2] (★) button to hide the "★" mark.

Recalling a registered drum kit

1. On the KIT screen (p. 13), press the [F1] (LIST) button.
2. Press the [F4] (▶ ALL ★) button.

A list of drum kits registered as favorites is shown.

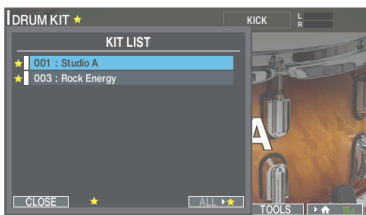

3. Use the cursor [▲] [▼] buttons or the dial to select a drum kit.
4. Press the [KIT] button to return to the KIT screen.

Recording your performance

You can easily record your own performance and play it back.

This lets you make a DRUM REC recording as performance data (MIDI), or an AUDIO REC recording as audio data (WAV).



For details, refer to "Reference Manual" (Roland website).

Customizing a drum kit

The V71 lets you shape your sounds in a wide variety of ways, from customizing the sound of the drum itself by changing the head type or shell depth, to adjusting the reverberation.

| Button | Explanation |
|---------------------|---|
| [INSTRUMENT] button | Sets the instrument (sound). |
| [EQ/COMP] button | Configures the equalizer, compressor and other effects for each pad or drum kit. |
| [MIXER] button | Configures the volume, pan and other effects for each pad or drum kit. |
| [AMBIENCE] button | Sets the sound heard from the overhead mic that picks up sounds from the entire drum kit, how the drums reverberate depending on where they are played and how the drums sound. |
| [BUS FX] button | Sets the effects assigned to the bus (the signal path that the audio is sent through) and the routing (the order in which the effects are connected). |
| [OTHERS] button | Configures various settings for the drum kit. |

Saving the settings

Since the V71 automatically saves the values that you change, there's no need to perform a specific operation to save your settings.

Settings are also saved when you turn off the power.

Editing Instruments (INSTRUMENT)

Here's how to configure the snare drum, kick drum and other instrument sounds.

Selecting the instruments

➔ Refer to the "Reference Manual" (Roland website) for the instruments you can select.

1. Press the [INSTRUMENT] button.

Selecting the pads to set

Selecting by striking the pad

To edit the settings for a pad, strike that pad to select it.

To select the rim of a pad, strike the rim.

MEMO

By pressing the [LOCK] button to make it light up, you can make the pad not switch to a different pad even if you strike it. This is useful if you're playing a phrase while you set the pads.

Selecting a pad with the SELECT [◀] [▶] buttons

You can also use the SELECT [◀] [▶] buttons to select the pad (trigger input number) you want to set.

When using a pad that supports rim playing, use the [RIM] button to select whether to set the head or the rim. For pads that support three-way triggering, this switches between the head, rim and bell.

The [RIM] button lights when the rim or bell is selected.

2. Press the [F1] (INST) button.

The INSTRUMENT screen appears.

Instrument group

Instrument bank

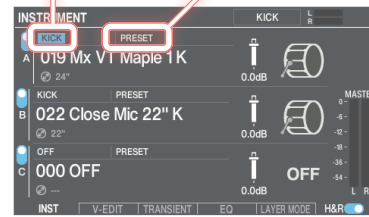

3. Select the pad to set (p. 18).

4. Press the cursor buttons to move the cursor to the instrument.



5. Use the [-] [+] buttons or the dial to select the instrument.

MEMO

You can also press the [ENTER] button to select an instrument from the list.

6. Press the [KIT] button to return to the KIT screen.

MEMO

Also, audio files that you created on your computer can be imported from an SD card or from the V71 Editor into the V71, and played as instruments (p. 22).

Previewing a pad's sound ([HEAD PREVIEW] button/[RIM] (PREVIEW) button)

Press the [HEAD PREVIEW] button/[RIM] (PREVIEW) button to hear the sound of the currently selected pad.

The volume changes in response to how hard you press the buttons. You can also specify a fixed volume. For details, refer to "Reference Manual" (Roland website).

MEMO

Press the [HEAD PREVIEW] button/[RIM] (PREVIEW) button while holding down the [SHIFT] button to hear different kinds of sounds (such as the sound of playing a snare drum closer to the rim, shallow rim and cross-stick shots, closed hi-hats, ride cymbal bells and so on).

Editing instruments in detail (V-EDIT)

V-EDIT lets you create drum sounds in the same way as you would with acoustic drums, such as by choosing and tuning the heads, muffling (muting) the sound and so on.

→ See the “Reference Manual” (Roland website) for the parameters that can be configured.

1. Press the [INSTRUMENT] button.
2. Press the [F2] (V-EDIT) button.

The V-EDIT screen appears.



3. Select the pad to set (p. 18).
4. Use the cursor buttons to select a parameter, and use the [-] [+] buttons or the dial to edit the value.
5. Press the [KIT] button to return to the KIT screen.

Adjusting the tonal character of the pads or drum kit (EQ/COMP)

You can adjust how the volume changes (kit compressor/pad compressor) or adjust the tonal character (kit equalizer/pad equalizer) for the individual pads and drum kits.

→ See the “Data List” (Roland website) for the parameters that can be configured.

1. Press the [EQ/COMP] button.
2. Press the function buttons to access the respective settings screens.

| | |
|-------------------------------|---|
| <p>PAD EQ screen</p> | <p>Configures the equalizer for each pad. You can configure the sounds for the head and rim separately.</p> |
| <p>PAD COMP screen</p> | <p>Configures the compressor for each pad. The head and rim use these settings in common.</p> |

| | |
|-------------------------------|--|
| <p>KIT COMP screen</p> | <p>Configures the compressor for the entire drum kit, on a kit-by-kit basis.</p> |
| <p>KIT EQ screen</p> | <p>Configures the equalizer for the entire drum kit, on a kit-by-kit basis.</p> |

3. Select the pad to set (only PAD EQ or PAD COMP) (p. 18).
4. Press the [F5] button to switch the equalizer/compressor on/off.
5. Edit the equalizer/compressor settings.
6. Press the [KIT] button to return to the KIT screen.

Editing the mixer (MIXER)

Here's how to set the volume, pan and other effects for each pad or drum kit.

→ See the “Data List” (Roland website) for the parameters that can be configured.

1. Press the [MIXER] button.
2. Press the function buttons to access the respective settings screens.

| | |
|-------------------------------------|--|
| <p>VOLUME/PAN screen</p> | <p>Sets the volume and pan for each pad.</p> |
| <p>MINIMUM VOLUME screen</p> | <p>Sets the minimum volume of each pad.</p> |
| <p>KIT VOLUME screen</p> | <p>Sets the drum kit volume.</p> |

3. Edit the mixer settings.
4. Press the [KIT] button to return to the KIT screen.

Recreating the reverberations of a performance location (AMBIENCE)

Here's how to recreate the ambience, meaning the sound heard from the overhead mic that picks up sounds from the entire drum kit, how the drums reverberate depending on where they are played and how the drums sound.

You can obtain a more natural and present drum sound by adjusting the overhead mic sound, the type of room and its size (room ambience), and the reverberation (reverb).

→ See the "Reference Manual" (Roland website) for the parameters that can be configured.

1. Press the [AMBIENCE] button.

The AMBIENCE screen appears.

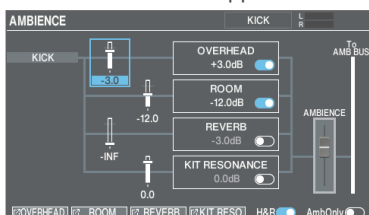

2. Press the function buttons to access the respective settings screens.

| | |
|----------------------|---|
| OVERHEAD screen | Configures the overhead mic. |
| ROOM screen | Configures the room ambience. |
| REVERB screen | Configures the reverb. |
| KIT RESONANCE screen | Sets the amount of resonance for the entire drum kit. |

3. Edit the ambience settings.
4. On the respective screens, switch the ambience on/off.
5. Press the [KIT] button to return to the KIT screen.

Adding effects (BUS FX)

You can apply a variety of effects to each pad.

BUS FX lets you configure the effects assigned to the bus (the signal path that the audio is sent through) and the routing (the order in which the effects are connected).

There are four buses (BUS-A–D), and you can set two effects (FX1, FX2) for each bus.

→ See the "Reference Manual" (Roland website) for the parameters that can be configured.

1. Press the [BUS FX] button.
2. Press the function buttons to access the respective settings screens.

| | |
|-------------------|---|
| ROUTING screen | Configures the pad or bus routing. |
| PAD ASSIGN screen | Configures the routing for each pad in list format. |
| PAD SEND screen | Configures the bus effect send amount for each pad. |
| FX EDIT screen | Configures the FX1 and FX2 effects for BUS-A–D. |
| SIDE CHAIN screen | Configures the side chain. |
| BUS REVERB screen | Configures the reverb that is applied to the bus. |

3. Edit the effect settings.
4. Press the [KIT] button to return to the KIT screen.

Editing a drum kit (OTHERS)

Here's where you can configure the various kit-related parameters such as drum kit volume, controller LED color and so on.

➔ See the "Data List" (Roland website) for the parameters that can be configured.

1. Press the [OTHERS] button.

The KIT OTHERS screen appears.

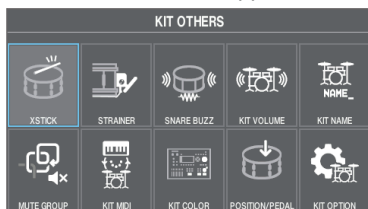

2. Use the cursor buttons or the dial to select the menu that you want to edit, and press the [ENTER] button.

| Menu | Explanation |
|----------------|--|
| XSTICK | Sets the cross-stick volume. |
| STRAINER | Configures the strainer settings. |
| SNARE BUZZ | Sets the resonance that's applied to the snare. |
| KIT VOLUME | Sets the drum kit volume. |
| KIT NAME | Edits the name of the drum kit. |
| MUTE GROUP | Sets the mute group. |
| KIT MIDI | Configures the MIDI-related settings for the drum kit. |
| KIT COLOR | Lets you set the LED color for the buttons and dial. |
| POSITION/PEDAL | Sets the strike area for the head, rim and so on. |
| KIT OPTION | Sets the brush, drum kit tempo, KIT screen view and so on. |

Edit the settings according to the selected menu.

➔ For details on each menu, refer to the "Reference Manual" (Roland website).

3. Edit the drum kit settings.

4. Press the [KIT] button to return to the KIT screen.

Setting the drum kit volume (KIT VOLUME)

Here's how to set the drum kit volume.

1. In the KIT OTHERS screen, select "KIT VOLUME" and then press the [ENTER] button.

The KIT VOLUME screen appears.



2. Use the [-] [+] buttons or the dial to edit the values.

| | |
|-------|-------------|
| Value | -INF~+6.0dB |
|-------|-------------|

Setting the colors for the buttons and dial (KIT COLOR)

You can change the colors of the buttons on a kit-by-kit basis ([KIT] button, [-] [+] button, [HEAD PREVIEW] button, [RIM] (PREVIEW) button), as well as for the dial and strainer indicator.

This helps to distinguish between drum kits. For example, you could assign different colors to drum kits of different genres, or use the color as a guide when editing instruments.

1. In the KIT OTHERS screen, select "KIT COLOR" and then press the [ENTER] button.

The KIT COLOR screen appears.

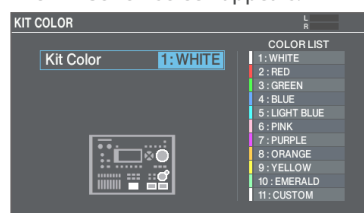

2. Use the dial to select the LED color.

3. Press the [KIT] button to return to the KIT screen.

Renaming the drum kit (KIT NAME)

Here's how to rename the currently selected drum kit.

1. In the KIT OTHERS screen, select "KIT NAME" and then press the [ENTER] button.

The KIT NAME screen appears.



2. Edit the name.

You can enter a kit name (upper line) of up to 16 characters, and a sub-name (lower line) of up to 64 characters.

| Controller | Explanation |
|-----------------------|--|
| Cursor buttons | Moves the cursor to the character that you want to change. |
| [-] [+] buttons, dial | Edits the character. |
| [F3] (A<>a) button | Toggles between uppercase/lowercase. |
| [F4] (>0) button | Selects numerical input. |
| [F5] (INSERT) button | Inserts a space at the cursor position. |
| [F6] (DELETE) button | Deletes the character at the cursor position. |

3. Press the [KIT] button to return to the KIT screen.

Importing and playing audio files (USER SAMPLE)

Audio files that you created on your computer can be imported from an SD card into the V71 and played as instruments (with the User Sample function). You can adjust the sound of a user sample and apply effects to it in the same way as with other instruments.

Audio files that can be loaded into the V71

| | WAV |
|--------------------|---------------------|
| Format (extension) | WAV (.wav) |
| Sampling frequency | 44.1, 48, 96 kHz |
| Bit rate | 16, 24, 32 bits |
| Time | Maximum 180 seconds |

* File names or folder names that contain more than 31 characters are not shown correctly. Also, file/folder names with double-byte characters are not supported.

Importing an audio file

Here's how to import an audio file into the V71 as a user sample.

1. Insert an SD card into the V71 (p. 4).
2. Hold down the [SHIFT] button and press the [EXPANSION] button.

The USER SAMPLE LIST screen appears.

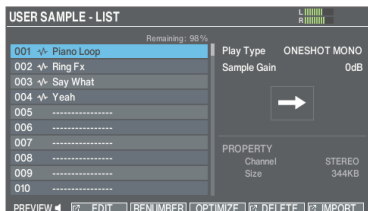

3. Use the cursor buttons to select the import destination number, and press the [F6] (IMPORT) button.

The USER SAMPLE IMPORT screen appears.

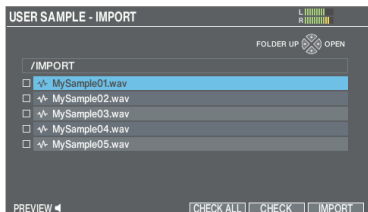

* If you select a number in which data already exists, the message "User Sample already exists!" appears. Select a number that contains no data.

4. Use the cursor buttons to select an audio file, and press the [F6] (IMPORT) button.

| Cursor buttons | Function |
|----------------|---------------------------|
| [▲] button | Moves cursor (up) |
| [▼] button | Moves cursor (down) |
| [◀] button | Closes (exits) the folder |

| Cursor buttons | Function |
|----------------|---------------------------|
| [▶] button | Opens (enters) the folder |

5. Press the [F6] (IMPORT) button.

A confirmation message appears.

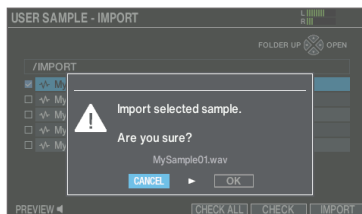

If you decide to cancel, select "CANCEL" and press the [ENTER] button.

6. Select "OK" and then press the [ENTER] button.

The audio file is imported.

MEMO

This unit can also import a group of audio files.

→ For details, refer to "Reference Manual" (Roland website).

Assigning a user sample to an instrument and playing it

1. Press the [INSTRUMENT] button.
2. Press the [F1] (INST) button.
3. Select the pad to set (p. 18).
4. Move the cursor to the Instrument category, and use the [-] [+] buttons or the dial to select "USER SAMPLE".



5. Move the cursor to the instrument, and use the [-] [+] buttons or the dial to select the user sample that you want to assign.

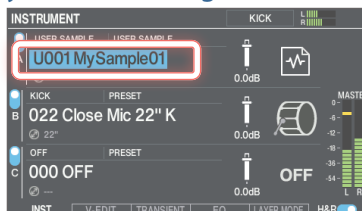

6. Press the [KIT] button to return to the KIT screen.

When you strike the pad to which the user sample is assigned, you hear that user sample.

Configuring the settings

Trigger settings

Here's how to configure the trigger settings, so that the signals from the pads can be accurately processed by the V71.

Specify the pad type

You can specify the type of pad (trigger type) used by the trigger bank for each trigger input.

Trigger type

The trigger type is a collection of various trigger parameters, adjusted to values that are appropriate for each pad. In order to make the optimal settings for the pad that's being used for each trigger input, specify the model (type) of pad that's connected.

Trigger bank

A trigger bank contains an entire set of settings for 14 triggers.

MEMO

For more on the trigger banks, refer to the "Reference Manual" (Roland website).

1. Press the [TRIGGER] button.
2. Press the [F1] (BANK) button.

The TRIGGER - BANK screen appears.

Trigger bank number



Trigger type

3. Use the [-] [+] buttons or the dial to specify the trigger bank.

- * You can't change the trigger type of a trigger input that's assigned to a pad that supports a digital connection.
→ For details on the trigger settings, refer to the "Reference Manual" (Roland website).

Adjusting the sensitivity for individual pads

Here's how to adjust the sensitivity of the pads, to control the balance between how hard you strike the pads and the volume.

1. Press the [TRIGGER] button.
2. Press the [F3] (BASIC) button.

The TRIGGER - BASIC screen appears.

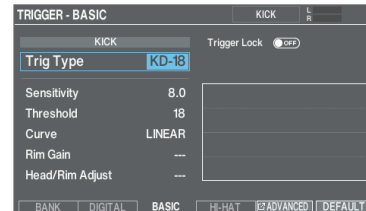

3. Select the pad to set (p. 18).
4. Press the cursor buttons to select "Sensitivity".
5. Use the [-] [+] buttons or the dial to adjust the sensitivity.
→ For details on adjusting the pad sensitivity, refer to the "Reference Manual" (Roland website).

Configuring the Instrument Expansions

Here's how to configure the Instrument Expansions (drum kit and instrument packages) that you've installed from Roland Cloud.

➔ For details on the Instrument Expansion settings, refer to the "Reference Manual" (Roland website).

1. Press the [EXPANSION] button.
2. Press the function buttons to access the respective settings screens.

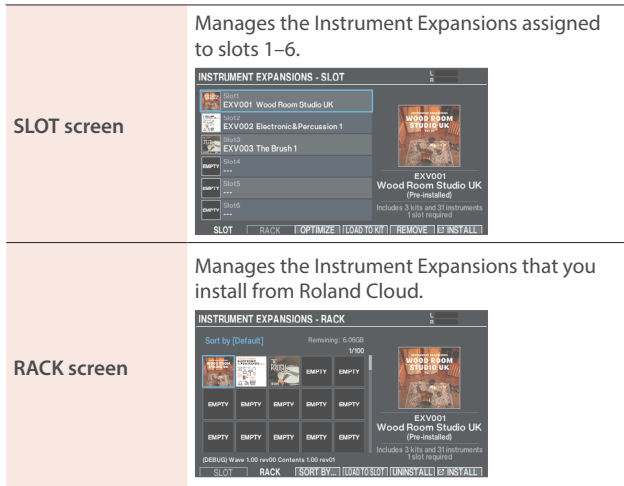

3. Edit the settings for the Instrument Expansions.
4. Press the [KIT] button to return to the KIT screen.

Importing drum kits and instruments from Roland Cloud

You can use one of the following two methods to install Instrument Expansions (drum kit and instrument packages) from Roland Cloud into the V71.

- Install by connecting the V71 to the Roland Cloud Connect smartphone app via Wi-Fi
 - ➔ Refer to the "Roland Cloud Connect Setup Guide" (separate document).
- Save the Instrument Expansion from the Roland Cloud Manager app on your computer to an SD card, and install via SD card
 - ➔ Refer to the "Roland Cloud User's Guide" (Roland website).

Backing up data

All settings stored in the V71 can be saved (backed up) to an SD card, or restored (loaded) back to the V71.

* To back up data to an SD card, first make sure that the SD card is inserted (p. 4).

MEMO

You can also back up and load individual drum kits.

➔ For details, refer to the "Reference Manual" (Roland website).

Formatting an SD card

Follow these steps to initialize (format) an SD card.

* SD cards must be formatted the first time before they are used on the V71.

NOTE

When you format an SD card, all data on the SD card is erased.

1. Insert the SD card into the V71 (p. 4).
2. Press the [BACKUP] button.
3. Use the cursor buttons or the dial to select "SD CARD FORMAT", and press the [ENTER] button.

The SD CARD FORMAT screen appears.



4. Press the [F6] (FORMAT) button.

A confirmation message appears.

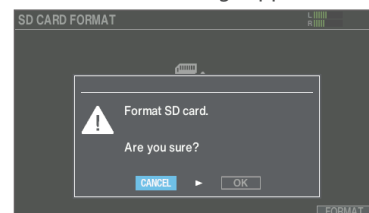

If you decide to cancel, select "CANCEL" and press the [ENTER] button.

5. Select "OK" and then press the [ENTER] button.
The SD card is initialized.
6. Press the [ENTER] button to finish the operation.

Backing up to an SD card (SAVE)

Here's how to save all settings that are stored in the V71 (up to 99 sets).

1. Insert the SD card into the V71 (p. 4).
2. Press the [BACKUP] button.
3. Use the cursor buttons or the dial to select "SAVE" and press the [ENTER] button.

The SD CARD SAVE ALL screen appears.

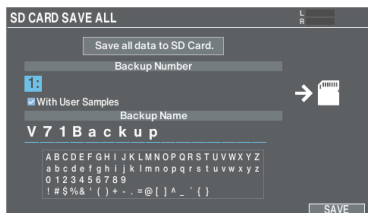

4. Configure the backup.

Parameter select: use cursor buttons
Value select: use [-] [+] buttons or dial

| Parameter | Explanation |
|-------------------|--|
| Backup Number | Selects the backup number. |
| With User Samples | Selects whether user samples are also backed up. |
| Backup Name | Adds a name to the backup data. |

- * If you back up user samples as well, it may take several minutes to save the data depending on the size of the user samples.
- * If you don't back up the user samples, and you then delete user samples or renumber them, the drum kit is not reproduced correctly even if you load the backup.

5. Press the [F6] (SAVE) button.

A confirmation message appears.

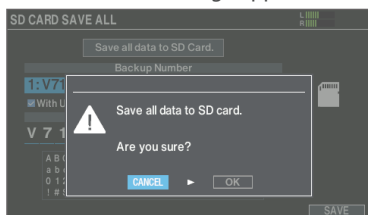

If you decide to cancel, select "CANCEL" and press the [ENTER] button.

6. Select "OK" and then press the [ENTER] button.
The settings are saved to the SD card.
7. Press the [ENTER] button to finish the operation.

Loading backup data from an SD card (LOAD)

Here's how you can load backup data into the V71 that's saved on an SD card.

1. Insert the SD card into the V71 (p. 4).
2. Press the [BACKUP] button.
3. Use the cursor buttons or the dial to select "LOAD" and press the [ENTER] button.

The SD CARD LOAD ALL screen appears.

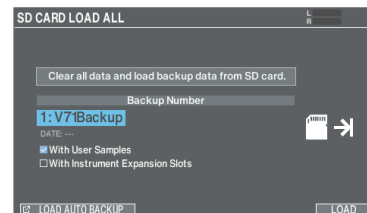

4. Configure the load settings.

Parameter select: use cursor buttons
Value select: use [-] [+] buttons or dial

| Parameter | Explanation |
|---------------------------------|--|
| Backup Number | Selects the backup number. |
| With User Samples | Selects whether user samples are also loaded. |
| With Instrument Expansion Slots | Selects whether to load the Instrument Expansions. * You can't load Instrument Expansions into a slot if they aren't installed in the rack (p. 12). |

- * When you load user samples, all user samples already present in this unit are overwritten. Depending on the size of the user samples, it might take ten minutes or more to load the data.

5. Press the [F6] (LOAD) button.

A confirmation message appears.

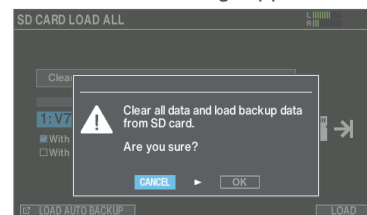

If you decide to cancel, select "CANCEL" and press the [ENTER] button.

6. Select "OK" and then press the [ENTER] button.
The backup data is loaded from the SD card.
7. Press the [ENTER] button to finish the operation.

Making overall settings for the V71 (SETUP)

The settings below are common to the entire V71, such as specifying the output destination of the V71 and configuring the footswitch assignments.

1. Press the [SETUP] button.

The SETUP screen appears.

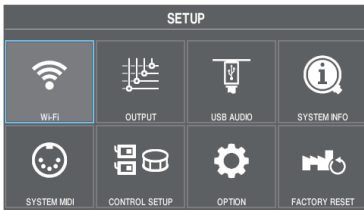

2. Use the cursor buttons or the dial to select the menu that you want to edit, and press the [ENTER] button.

| Menu | Explanation |
|---------------|---|
| Wi-Fi | Lets you connect the V71 to the Roland Cloud Connect app via Wi-Fi. |
| OUTPUT | Specifies the output destination of the sounds. |
| USB AUDIO | Configures the USB audio. |
| SYSTEM INFO | Used for checking how much memory is free on this unit, as well as the program version. |
| SYSTEM MIDI | Configures the overall MIDI-related settings for the V71. |
| CONTROL SETUP | Assigns functions to the footswitches and pads. |
| OPTION | Configures the preview button, audio input, display, Auto Off and so on. |
| FACTORY RESET | Restores the factory settings. |

3. Edit the settings according to the selected menu.

➔ For details on each menu, refer to the "Reference Manual" (Roland website).

Using this unit with a computer or smartphone app

You can connect the V71 to your computer or smartphone to do the following things.

- Connect this unit to your computer (Windows/Mac) and record 32 channels of multitrack audio with your DAW software, or record your performance as MIDI data (VENDOR).
- You can directly exchange audio/MIDI data between this unit and your smartphone or tablet (GENERIC).

Connecting to a computer (Mac/Windows)

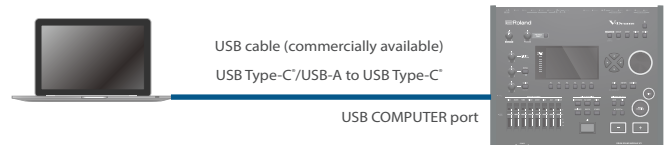

Connecting to an iPhone/iPad

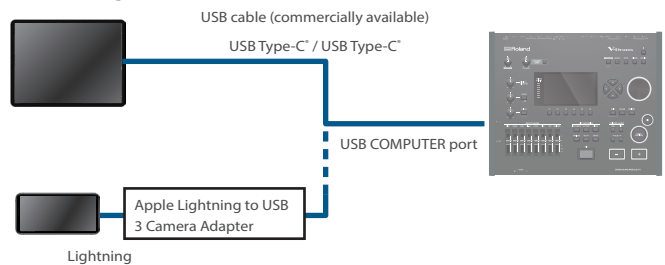

- * We have confirmed that audio noise may occur when connecting to certain Apple products featuring a Lightning connector using Apple's Lightning to USB Camera Adapter. This may be resolved by using the Lightning to USB 3 Camera Adapter instead. For more details and for the latest support information, see "V71 Support Information".
- * See the product information released by Apple for the differences between the Lightning to USB Camera Adapter and the Lightning to USB 3 Camera Adapter.

Configuring the USB driver

This shows how to switch between the dedicated USB driver for the V71 (VENDOR) and the OS standard driver (GENERIC).

1. Press the [SETUP] button.
2. Select "USB AUDIO" and press the [ENTER] button.
3. Move the cursor to Driver Mode, and use the [-] [+] buttons or the dial to change the value.

| Parameter | Value | Explanation |
|-------------|---------|---|
| Driver Mode | GENERIC | Uses the driver provided by the operating system. USB MIDI and USB audio (2 ch. recording and playback) can be used. |
| | VENDOR | Uses the V71's dedicated driver provided by Roland. USB MIDI and USB audio (32 ch. recording and playback) can be used. |

MEMO

The setting takes effect when the V71 is powered off and on again.

4. Turn the power off, and then on again

MEMO

For details on downloading and installing the USB driver, refer to the Roland website.

<https://www.roland.com/support/>

Using V71 Editor on your computer

You can use the V71 Editor app to edit the sounds of the V71 on your computer (Windows/Mac). This makes it more convenient to edit sounds by taking advantage of the computer's larger display.

For details, refer to "Reference Manual" (Roland website).

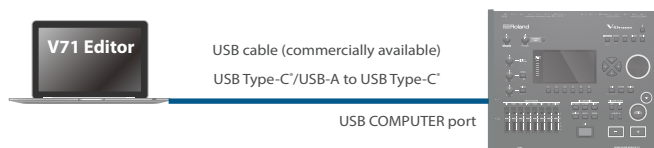

Restoring the factory settings

This restores the settings stored in the V71 to their factory default values. This is called a "factory reset".

NOTE

When you execute this operation, all data and settings in the V71 are lost. Save any important data and settings to your SD card (p. 24) before you do this.

1. In the SETUP screen, select "FACTORY RESET" and then press the [ENTER] button.

The FACTORY RESET screen appears.

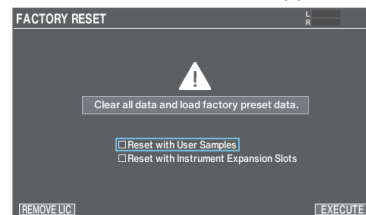

Parameter select: use cursor buttons

Value select: use [-] [+] buttons or dial

| Parameter | Explanation |
|---------------------------------------|---|
| Reset with User Samples | Selects whether to restore all user samples that have been imported into the V71 to their factory settings. * All user samples in user memory are overwritten by the factory-set data. |
| Reset with Instrument Expansion Slots | Selects whether to restore the Instrument Expansions loaded into the slots to their factory settings (p. 12). |

2. Press the [F6] (EXECUTE) button.

A confirmation message appears.

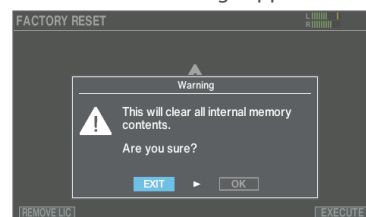

If you decide to cancel, select "EXIT" and press the [ENTER] button.

3. Select "OK" and then press the [ENTER] button.

This executes the factory reset.

4. Press the [ENTER] button to finish the operation.

The HI-HAT OFFSET CALIBRATION screen appears.

5. Press the [F6] (ADJUST) button and follow step 4 in "Configuring the hi-hat" (p. 8) to configure the hi-hat.

Restoring the drum kit to factory settings

You can use the copy function to restore drum kits to their factory (preset kit) settings.

1. Hold down the [SHIFT] button and press the [BACKUP] button.

The COPY screen appears.

2. Use the cursor buttons or the dial to select "KIT" and press the [ENTER] button.

3. Press the [F2] (PRESET) button.

The COPY KIT FROM PRESET DATA screen appears.

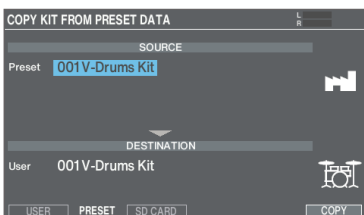

4. Move the cursor to the preset kit, and use the [-] [+] buttons or the dial to select the preset kit with the same number as the kit you wish to restore to the factory settings.

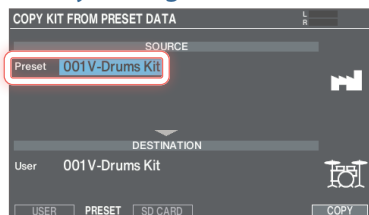

5. Move the cursor to the user kit, and use the [-] [+] buttons or the dial to select the kit you want to restore to preset settings.

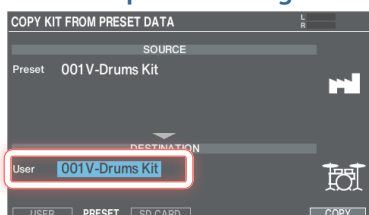

6. Press the [F6] (COPY) button.

A confirmation message appears.

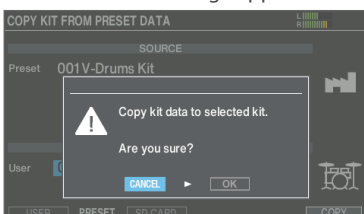

If you decide to cancel, select "CANCEL" and press the [ENTER] button.

7. Select "OK" and then press the [ENTER] button.

This copies the kit.

USING THE UNIT SAFELY

WARNING

Use only the supplied AC adaptor and the correct voltage

Be sure to use only the AC adaptor supplied with the unit. Also, make sure the line voltage at the installation matches the input voltage specified on the AC adaptor's body. Other AC adaptors may use a different polarity, or be designed for a different voltage, so their use could result in damage, malfunction, or electric shock.



Use only the supplied power cord

Use only the attached power cord. Also, the supplied power cord must not be used with any other device.



CAUTION

Keep small items out of the reach of children

To prevent accidental ingestion of the parts listed below, always keep them out of the reach of small children.

- Removable Parts
Screws (p. 4)



Handle the ground terminal carefully

If you remove the screw from the ground terminal, be sure to replace it; don't leave it lying around where it could accidentally be swallowed by small children. When refastening the screw, make that it is firmly fastened, so it won't come loose.



English

日本語

Deutsch

Français

Italiano

Español

Português

Nederlands

IMPORTANT NOTES

Power Supply

- Place the AC adaptor so the side with the indicator faces upwards. The indicator will light when you plug the AC adaptor into an AC outlet.

Placement

- Depending on the material and temperature of the surface on which you place the unit, its rubber feet may discolor or mar the surface.

Repairs and Data

- Before sending the unit away for repairs, be sure to make a backup of the data stored within it; or you may prefer to write down the needed information. Although we will do our utmost to preserve the data stored in your unit when we carry out repairs, in some cases, such as when the memory section is physically damaged, restoration of the stored content may be impossible. Roland assumes no liability concerning the restoration of any stored content that has been lost.

Additional Precautions

- Any data stored within the unit can be lost as the result of equipment failure, incorrect operation, etc. To protect yourself against the irretrievable loss of data, be sure to make a backup of the data stored within it; or you may prefer to write down the needed information.
- Roland assumes no liability concerning the restoration of any stored content that has been lost.
- Never strike or apply strong pressure to the display.
- This instrument is designed to minimize the extraneous sounds produced when it's played. However, since sound vibrations can be transmitted through floors and walls to a greater degree than expected, take care not to allow these sounds to become a nuisance others nearby.
- Do not use connection cables that contain a built-in resistor.



Using External Memories

- Please observe the following precautions when handling external memory devices. Also, make sure to carefully observe all the precautions that were supplied with the external memory device.
 - Do not remove the device while reading/writing is in progress.
 - To prevent damage from static electricity, discharge all static electricity from your person before handling the device.

Caution Regarding Radio Frequency Emissions

- The following actions may subject you to penalty of law.
 - Disassembling or modifying this device.
 - Removing the certification label affixed to the back of this device.
 - Using this device in a country other than where it was purchased
- This unit cannot be used to directly connect to a network operated by a telecommunications provider (such as a mobile or landline-based telecommunications company, an Internet provider or the likes), including a public wireless LAN. You must use a router or similar equipment when connecting this unit to the Internet.

Intellectual Property Right

- It is forbidden by law to make an audio recording, video recording, copy or revision of a third party's copyrighted work (musical work, video work, broadcast, live performance, or other work), whether in whole or in part, and distribute, sell, lease, perform, or broadcast it without the permission of the copyright owner.
- Do not use this product for purposes that could infringe on a copyright held by a third party. We assume no responsibility whatsoever with regard to any infringements of third-party copyrights arising through your use of this product.
- The copyright of content in this product (the sound waveform data, style data, accompaniment patterns, phrase data, audio loops and image data) is reserved by Roland Corporation.
- Purchasers of this product are permitted to utilize said content (except song data such as Demo Songs) for the creating, performing, recording and distributing original musical works.
- Purchasers of this product are NOT permitted to extract said content in original or modified form, for the purpose of distributing recorded medium of said content or making them available on a computer network.
- The SD logo , SDHC logo  and SDXC logo  are trademarks of SD-3C, LLC.
- ASIO is a trademark and software of Steinberg Media Technologies GmbH.
- This product contains eParts integrated software platform of eSOL Co.,Ltd. eParts is a trademark of eSOL Co., Ltd. in Japan.
- The **Bluetooth**[®] word mark and logos are registered trademarks owned by Bluetooth SIG, Inc. and any use of such marks by Roland is under license.
- This Product uses the Source Code of μ T-Kernel under T-License 2.0 granted by the T-Engine Forum (www.tron.org).

- This product includes third party open source software.

Copyright © 2009-2018 ARM Limited. All rights reserved.
Licensed under the Apache License, Version 2.0 (the "License");
You may obtain a copy of the License at <http://www.apache.org/licenses/LICENSE-2.0>

Copyright © 2016 Freescale Semiconductor, Inc.
Copyright © 2016-2017 NXP. All rights reserved.
Licensed under the BSD-3-Clause;
You may obtain a copy of the License at <https://opensource.org/licenses/BSD-3-Clause>

Copyright © 2009-2018 Arm Limited. All rights reserved.
Copyright © 2018 STMicroelectronics. All rights reserved.
Licensed under the Apache License, Version 2.0 (the "License");
You may obtain a copy of the License at <http://www.apache.org/licenses/LICENSE-2.0>

Copyright © 2018 STMicroelectronics. All rights reserved.
This software component is licensed by ST under BSD 3-Clause license, the "License";
You may obtain a copy of the License at <https://opensource.org/licenses/BSD-3-Clause>

- Roland and V-Drums are either registered trademarks or trademarks of Roland Corporation in the United States and/or other countries.
- Company names and product names appearing in this document are registered trademarks or trademarks of their respective owners.
- In this manual, company names and product names of the respective owners are used because it is the most practical way of describing the sounds that are emulated using DSP technology.

* This document explains the specifications of the product at the time that the document was issued. For the latest information, refer to the Roland website.